

72TD

ESTREMITA' TUBOLARE METRICA METRIC STANDPIPE

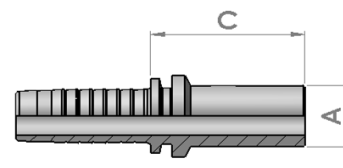

part ref.	Hose ID		Duty	Dimension (mm)			Weight Kg
	[in]	size		Tube A	Cut-off C		
72TD0603	3/16"	03	L/S	6	30		0,008
72TD0803	3/16"	03	L/S	8	29		0,010
72TD0604	1/4"	04	L	6	32		0,011
72TD0804	1/4"	04	L/S	8	29		0,013
72TD1004	1/4"	04	L/S	10	32		0,018
72TD1204	1/4"	04	L/S	12	30		0,020
72TD0805	5/16"	05	L/S	8	29		0,015
72TD1005	5/16"	05	L/S	10	30		0,019
72TD1205	5/16"	05	L/S	12	32		0,023
72TD1006	3/8"	06	L	10	31		0,022
72TD1206	3/8"	06	L/S	12	31		0,026
72TD1406	3/8"	06	S	14	36		0,039
72TD1506	3/8"	06	L	15	32		0,036
72TD1408	1/2"	08	S	14	37		0,047
72TD1508	1/2"	08	L	15	33		0,048
72TD1608	1/2"	08	S	16	38		0,058
72TD1808	1/2"	08	L	18	34		0,061
72TD1810	5/8"	10	L	18	34		0,066
72TD2010	5/8"	10	S	20	44		0,078
72TD2210	5/8"	10	L	22	36		0,071
72TD1812	3/4"	12	L	18	34		0,090
72TD2012	3/4"	12	S	20	45		0,094
72TD2212	3/4"	12	L	22	36		0,096
72TD2512	3/4"	12	S	25	49		0,120
72TD2516	1"	16	S	25	49		0,164
72TD2816	1"	16	L	28	39		0,188
72TD3016	1"	16	S	30	54		0,228
72TD3020	1.1/4"	20	S	30	55		0,281
72TD3520	1.1/4"	20	L	35	47		0,278
72TD3820	1.1/4"	20	S	38	61		0,326
72TD3824	1.1/2"	24	S	38	61		0,386
72TD4224	1.1/2"	24	L	42	49		0,375