

72NGS

FEMMINA 90° BSPP SPINATA
SV.60° CON O-RING
BSPP O-RING 90° FEMALE 60° FLARE THRUST
WIRE NUT

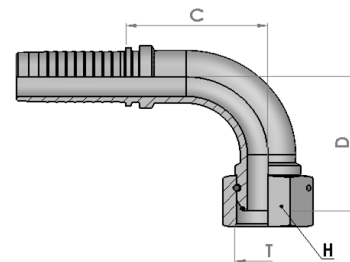

part ref.	Hose ID		Thread	Dimension (mm)				Weight Kg
	[in]	size		hex T	hex H	Cut-off C	Drop D	
72NGS1212	3/4"	12	3/4-14	32	56	54	0,257	
72NGS1612	3/4"	12	1-11	38	56	58	0,313	
72NGS1616	1"	16	1-11	38	70	65	0,448	
72NG2020	1.1/4"	20	1.1/4-11	50	85	86	0,692	
72NG2424	1.1/2"	24	1.1/2-11	55	99	100	1,156	
72NG3232	2"	32	2-11	70	128	127	2,174	
72NG4040*	2.1/2"	40	2.1/2-11	85	94	103	3,000	
72NG4848*	3"	48	3-11	100	117	128	3,950	

*SENZA O-RING / *WITHOUT O-RING

72QGS

FEMMINA 45° BSPP SPINATA
SV.60° CON O-RING
BSPP O-RING 45° FEMALE 60° FLARE THRUST
WIRE NUT

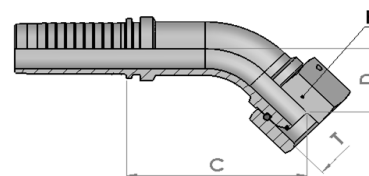

part ref.	Hose ID		Thread	Dimension (mm)				Weight Kg
	[in]	size		hex T	hex H	Cut-off C	Drop D	
72QGS1212	3/4"	12	3/4-14	32	84	27	0,239	
72QGS1612	3/4"	12	1-11	38	84	30	0,313	
72QGS1616	1"	16	1-11	38	84	35	0,404	
72QG2020	1.1/4"	20	1.1/4-11	50	103	50	0,693	
72QG2424	1.1/2"	24	1.1/2-11	55	116	55	1,045	
72QG3232	2"	32	2-11	70	143	70	2,030	
72QG4040*	2.1/2"	40	2.1/2-11	85	100	47	3,000	
72QG4848*	3"	48	3-11	100	123	57	3,950	

*SENZA O-RING / *WITHOUT O-RING

72FGO

FEMMINA DIRITTA BSPP SV.60° CON O-RING
BSPP STRAIGHT FEMALE 60° FLARE WITH O-RING

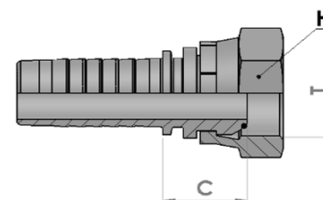

part ref.	Hose ID		Thread	Dimension (mm)			Weight Kg
	[in]	size		hex T	hex H	Cut-off C	
72FGO0404	1/4"	04	1/4-19	19	17	0,042	
72FGO0606	3/8"	06	3/8-19	22	20	0,047	
72FGO0808	1/2"	08	1/2-14	27	21	0,081	