

72QG

FEMMINA 45° BSPP SV.60° BSPP 45° FEMALE 60° FLARE

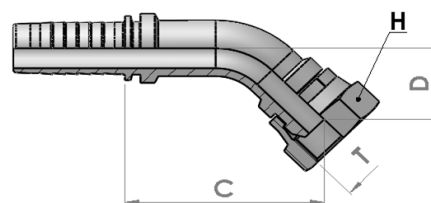

part ref.	Hose ID		Thread	Dimension (mm)				Weight Kg
	[in]	size		hex T	hex H	Cut-off C	Drop D	
72QG0203	3/16"	03	1/8-28	14	34	16	0,021	
72QG0403	3/16"	03	1/4-19	19	39	16	0,036	
72QG0404	1/4"	04	1/4-19	19	35	16	0,041	
72QG0604	1/4"	04	3/8-19	22	43	18	0,056	
72QG0605	5/16"	05	3/8-19	22	50	19	0,061	
72QG0606	3/8"	06	3/8-19	22	43	19	0,068	
72QG0806	3/8"	06	1/2-14	27	53	20	0,092	
72QG0808	1/2"	08	1/2-14	27	50	23	0,117	
72QG1008	1/2"	08	5/8-14	30	65	24	0,137	
72QG1208	1/2"	08	3/4-14	32	65	23	0,156	
72QG1010	5/8"	10	5/8-14	30	60	26	0,142	
72QG1210	5/8"	10	3/4-14	32	70	26	0,180	
72QG1212	3/4"	12	3/4-14	32	84	27	0,220	
72QG1612	3/4"	12	1-11	38	87	30	0,320	
72QG1616	1"	16	1-11	38	84	35	0,374	

72FGS

FEMMINA DIRITTA BSPP SPINATA SV.60° CON O-RING BSPP O-RING STRAIGHT FEMALE 60° FLARE THRUST WIRE NUT

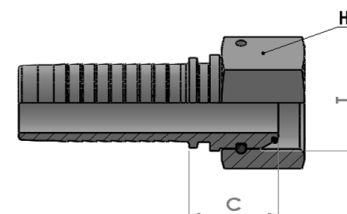

part ref.	Hose ID		Thread	Dimension (mm)				Weight Kg
	[in]	size		hex T	hex H	Cut-off C		
72FGS1212	3/4"	12	3/4-14	32	26		0,156	
72FGS1612	3/4"	12	1-11	38	27		0,190	
72FGS1616	1"	16	1-11	38	28		0,244	
72FG2016	1"	16	1.1/4-11	50	30		0,413	
72FG2020	1.1/4"	20	1.1/4-11	50	32		0,452	
72FG2420	1.1/4"	20	1.1/2-11	55	34		0,523	
72FG2424	1.1/2"	24	1.1/2-11	55	34		0,575	
72FG3224	1.1/2"	24	2-11	70	31		0,856	
72FG3232	2"	32	2-11	70	31		0,930	
72FG4040*	2.1/2"	40	2.1/2-11	85	36		1,596	
72FG4848*	3"	48	3-11	100	40		2,145	

*SENZA O-RING

*WITHOUT O-RING