

72MG

MASCHIO BSPP CILINDRICO SV.60° BSPP PARALLEL MALE 60° FLARE

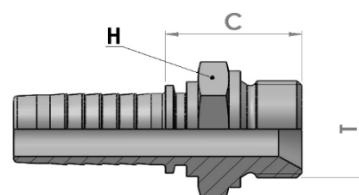

part ref.	Hose ID		Thread	Dimension (mm)			Weight Kg
	[in]	size		hex T	hex H	Cut-off C	
72MG0203	3/16"	03	1/8-28	14	21	0,015	
72MG0403	3/16"	03	1/4-19	19	26	0,029	
72MG0204	1/4"	04	1/8-28	14	21	0,018	
72MG0404	1/4"	04	1/4-19	19	27	0,032	
72MG0604	1/4"	04	3/8-19	22	28	0,047	
72MG0804	1/4"	04	1/2-14	27	32	0,070	
72MG0405	5/16"	05	1/4-19	19	27	0,034	
72MG0605	5/16"	05	3/8-19	22	28	0,050	
72MG0805	5/16"	05	1/2-14	27	32	0,073	
72MG0406	3/8"	06	1/4-19	19	27	0,040	
72MG0606	3/8"	06	3/8-19	22	29	0,051	
72MG0806	3/8"	06	1/2-14	27	32	0,076	
72MG0608	1/2"	08	3/8-19	22	29	0,060	
72MG0808	1/2"	08	1/2-14	27	33	0,089	
72MG1008	1/2"	08	5/8-14	30	34	0,100	
72MG1208	1/2"	08	3/4-14	32	35	0,123	
72MG0810	5/8"	10	1/2-14	27	33	0,097	
72MG1010	5/8"	10	5/8-14	30	34	0,120	
72MG1210	5/8"	10	3/4-14	32	35	0,130	
72MG0812	3/4"	12	1/2-14	27	34	0,118	
72MG1212	3/4"	12	3/4-14	32	36	0,141	
72MG1612	3/4"	12	1-11	41	39	0,210	
72MG1616	1"	16	1-11	41	40	0,280	
72MG2016	1"	16	1.1/4-11	50	44	0,339	
72MG2020	1.1/4"	20	1.1/4-11	50	45	0,434	
72MG2420	1.1/4"	20	1.1/2-11	55	46	0,460	
72MG2424	1.1/2"	24	1.1/2-11	55	46	0,514	
72MG3224	1.1/2"	24	2-11	70	53	0,862	
72MG3232	2"	32	2-11	70	53	0,935	
72MG4040	2.1/2"	40	2.1/2-11	85	52	1,413	
72MG4848	3"	48	3-11	100	52	2,180	