

**75NNFG ADATTATORE 90° F+F FISSA BSPP**  
ADAPTER F - F BSPP FIXED 90° ELBOW

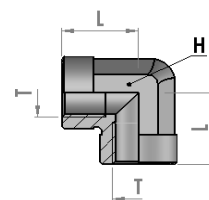

| part ref.  | Thread   | Dimension (mm) |             |
|------------|----------|----------------|-------------|
|            | T        | hex<br>H       | Length<br>L |
| 75NNFG0404 | 1/4-19   | 19             | 22,5        |
| 75NNFG0606 | 3/8-19   | 24             | 26          |
| 75NNFG0808 | 1/2-14   | 27             | 31          |
| 75NNFG1212 | 3/4-14   | 33             | 35          |
| 75NNFG1616 | 1-11     | 41             | 44          |
| 75NNFG2020 | 1.1/4-11 | 48             | 52          |

**753MMM** ADATTATORE M BSPP  
ADAPTER M BSPP - TEE

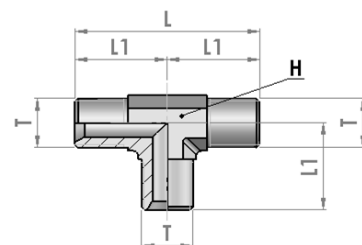

| part ref. | Thread   | Dimension (mm) |             |              |
|-----------|----------|----------------|-------------|--------------|
|           | T        | hex<br>H       | Length<br>L | Length<br>L1 |
| 753MMM04L | 1/4-19   | 14             | 49          | 24,5         |
| 753MMM06L | 3/8-19   | 16             | 55          | 27,5         |
| 753MMM08L | 1/2-14   | 22             | 69          | 34,5         |
| 753MMM12L | 3/4-14   | 27             | 80          | 40           |
| 753MMM16L | 1-11     | 33             | 92          | 46           |
| 753MMM20L | 1.1/4-11 | 41             | 104         | 52           |

**753MFMG** ADATTATORE M + F GIREVOLE + M BSPP  
ADAPTER M + SWIVEL F + M BSPP - TEE

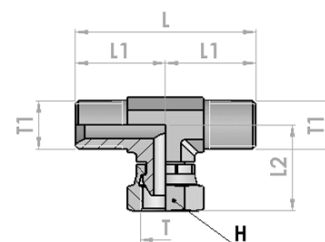

| part ref. | Thread   | Thread   | Dimension (mm) |             |              |              |
|-----------|----------|----------|----------------|-------------|--------------|--------------|
|           | T        | T1       | hex<br>H       | Length<br>L | Length<br>L1 | Length<br>L2 |
| 753MFMG04 | 1/4-19   | 1/4-19   | 19             | 49          | 24,5         | 29           |
| 753MFMG06 | 3/8-19   | 3/8-19   | 22             | 63          | 32           | 34           |
| 753MFMG08 | 1/2-14   | 1/2-14   | 27             | 69          | 34,5         | 41           |
| 753MFMG12 | 3/4-14   | 3/4-14   | 32             | 80          | 40           | 46           |
| 753MFMG16 | 1-11     | 1-11     | 41             | 100         | 50           | 52           |
| 753MFMG20 | 1.1/4-11 | 1.1/4-11 | 50             | 104         | 52           | 57           |