

72FL9 FLANGIA DIRITTA SUPERCAT STRAIGHT FLANGE SUPERCAT

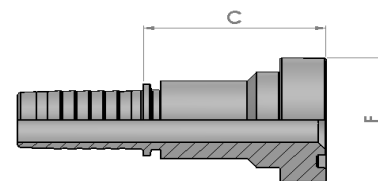

part ref.	Hose ID		Flange	Dimension (mm)			Weight
	[in]	size	Size F	Flange F	Cut-off C		Kg
72FL91212	3/4"	12	3/4"	41,3	57		0,293
72FL91612	3/4"	12	1"	47,6	64		0,381
72FL91616	1"	16	1"	47,6	65		0,469
72FL92016	1"	16	1.1/4"	54	72		0,561
72FL92020	1.1/4"	20	1.1/4"	54	74		0,699
72FL92420	1.1/4"	20	1.1/2"	63,5	78		0,885
72FL92424	1.1/2"	24	1.1/2"	63,5	80		0,875

72FLN9 FLANGIA 90° SUPERCAT 90° FLANGE SUPERCAT

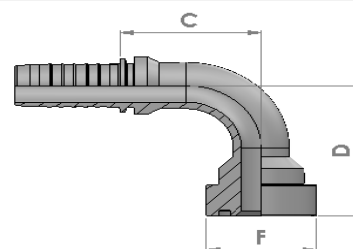

part ref.	Hose ID		Flange	Dimension (mm)			Weight
	[in]	size	Size F	Flange F	Cut-off C	Drop D	Kg
72FLN91212	3/4"	12	3/4"	41,3	56	61	0,355
72FLN91612	3/4"	12	1"	47,6	56	65	0,392
72FLN91616	1"	16	1"	47,6	71	78	0,577
72FLN92016	1"	16	1.1/4"	54	71	84	0,668
72FLN92020	1.1/4"	20	1.1/4"	54	90	86	0,905
72FLN92420	1.1/4"	20	1.1/2"	63,5	90	92	0,960
72FLN92424	1.1/2"	24	1.1/2"	63,5	108	104	1,455

72FLQ9 FLANGIA 45° SUPERCAT 45° FLANGE SUPERCAT

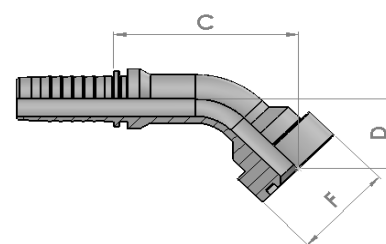

part ref.	Hose ID		Flange	Dimension (mm)			Weight
	[in]	size	Size F	Flange F	Cut-off C	Drop D	Kg
72FLQ91212	3/4"	12	3/4"	41,3	75	33	0,295
72FLQ91612	3/4"	12	1"	47,6	79	37	0,392
72FLQ91616	1"	16	1"	47,6	92	41	0,522
72FLQ92016	1"	16	1.1/4"	54,0	92	42	0,621
72FLQ92020	1.1/4"	20	1.1/4"	54,0	112	44	0,885
72FLQ92420	1.1/4"	20	1.1/2"	63,5	114	48	0,865
72FLQ92424	1.1/2"	24	1.1/2"	63,5	125	50	1,360