

VS FLUID

HYDRAULICS



HYDRAULIC HOSE
FITTINGS

part ref.	Raccordi Standard - Standard Fittings	Pag.
7176	Boccola S-7600 - Ferrule S-7600	01
7172	Boccola S-7200 - Ferrule S-7200	01
7155	Boccola S-5500 - Ferrule S-5500	02
71116	Boccola S-1160 - Ferrule S-1160	02
71110	Boccola S-1100 - Ferrule S-1100	02
71118	Boccola S-1180 - Ferrule S-1180	03
71120	Boccola S-1200 - Ferrule S-1200	03
72MG	Maschio BSPP sv.60° - BSPP male 60° flare	04
72MC	Maschio BSPT sv.60° - BSPT male 60° flare	05
72FG	Femmina BSPP SV.60° - BSPP female 60° flare	06
72NG	Femmina 90° BSPP SV.60° - BSPP 90° female 60° fl.	06
72QG	Femmina 45° BSPP SV.60° - BSPP 45° female 60° fl.	07
72FGS	Femm. BSPP spin.+OR - BSPP female wire nut +OR	07
72NGS	F.90° BSPP sp.+OR - BSPP 90° female wire nut +OR	08
72QGS	F.45° BSPP sp.+OR - BSPP 45° female wire nut +OR	08
72FGO	Femm. BSPP pinz.+OR - BSPP female crimped +OR	08
72NGO	F.90° BSPP pinz.+OR - BSPP female crimped +OR	09
72NGK	F.90° compatta BSPP - BSPP compact 90° female	09
72OG	Occhio BSPP - BSPP Banjo	10
74BFG	Bullone forato BSPP - BSPP Bolt	10
72MJ	Maschio JIC sv.74° - JIC male 74° flare	11
72FJ	Femmina JIC sv.74° - JIC female 74° flare	11
72NJ	Femmina 90° JIC sv.74° - JIC 90° female 74° flare	12
72QJ	Femmina 45° JIC sv.74° - JIC 45° female 74° flare	12
72FJS	Femmina JIC spin. sv.74° - JIC female wire nut 74° fl.	13
72NJS	F.90°JIC spin. sv.74° - JIC 90° female wire nut 74° fl.	13
72QJS	F.45°JIC spin. sv.74° - JIC 45° female wire nut 74° fl.	13
72ML	Maschio metrico DKOL 24°- Metric male L type 24° fl.	14
72FL	Femm. metrica DKOL 24°- Metric female DKOL 24° fl.	14
72NL	F.90° metrica DKOL 24°- 90°Metric female DKOL 24°	15
72QL	F.45° metrica DKOL 24°- 45°Metric female DKOL 24°	15
72MS	Maschio metrico DKOS 24°- Metric male S type 24° fl.	16
72FS	Femm. metrica DKOS 24°- Metric female DKOS 24° fl.	16
72NS	F.90° metrica DKOS 24°- 90°Metric female DKOS 24°	17
72QS	F.45° metrica DKOS 24°- 45°Metric female DKOS 24°	17
72TD	Estremità tubolare metrica - Metric standpipe	18
72TN	Estremità tubolare metrica 90° - Metric standpipe 90°	19
72TQ	Estremità tubolare metrica 45° - Metric standpipe 45°	20
72MM	Maschio metrico sv.60°- Metric male 60° flare	21
72FM	Femm. metrica sv. 60°- Metric female 60° flare	21
72NM	Femm.90° metrica sv. 60°- 90° Metric female 60° flare	22
72QM	Femm.45° metrica sv. 60°- 45° Metric female 60° flare	22
72OM	Occhio metrico - Metric Banjo	23
72BFM	Bullone forato metrico - Metric Bolt	23

part ref.	Raccordi Standard - Standard Fittings	Pag.
72MH	Maschio ORFS - ORFS male	24
72FH	Femmina ORFS - ORFS female	24
72NH	Femmina 90° ORFS - 90° ORFS female	25
72QH	Femmina 45° ORFS - 45° ORFS female	25
72MN	Maschio NPT sv.60°- NPT male 60° flare	26
72FY	Femmina "TOYOTA" sv.60° - "TOYOTA" female 60°fl.	27
72FYM	Femmina "KOMATSU"sv.60°-"KOMATSU"female 60°fl.	27
72KR10	Attacco pistole Idropulitrici-Gun wash cleaner junction	27
72KR22	Femmina per Idropulitrici-Female for water jet cleaner	28
72GT	Giunzione tubo flex - Flex hose junction	28
72SD	Maschio STAPLELOCK DIN-STAPLELOCK DIN male	29
72SS	Maschio STAPLELOCK SAE-STAPLELOCK SAE male	29
72FL3	Flangia diritta SAE 3000 - Straight flange SAE 3000	30
72FLN3	Flangia 90° SAE 3000 - 90° flange SAE 3000	30
72FLQ3	Flangia 45° SAE 3000 - 45° flange SAE 3000	31
72FL6	Flangia diritta SAE 6000 - Straight flange SAE 6000	31
72FLN6	Flangia 90° SAE 6000 - 90° flange SAE 6000	32
72FLQ6	Flangia 45° SAE 6000 - 45° flange SAE 6000	32
72FL9	Flangia diritta SUPERCAT-Straight flange SUPERCAT	33
72FLN9	Flangia 90° SUPERCAT- 90° flange SUPERCAT	33
72FLQ9	Flangia 45° SUPERCAT - 45° flange SUPERCAT	33

part ref.	Raccordi Interlock - Interlock Fittings	Pag.
71805	Boccola 4SH-R12 - Ferrule 4SH-R12	34
71905	Boccola 4SP-R13-R15 - Ferrule 4SP-R13-R15	34
72MC5	Maschio BSPT sv.60° - BSPT male 60° flare	35
72FG5	Femm. BSPP spin.+OR-BSPP female wire nut +OR	35
72NG5	F.90° BSPP sp.+OR-BSPP 90° female wire nut +OR	35
72QG5	F.45° BSPP sp.+OR-BSPP 45° female wire nut +OR	36
72MJ5	Maschio JIC sv.74° - JIC male 74° flare	36
72FJ5	Femmina JIC spin. sv.74° - JIC female wire nut 74° fl.	36
72NJ5	F. 90°JIC spin. sv.74° - JIC 90° female wire nut 74° fl.	37
72QJ5	F. 45°JIC spin. sv.74° - JIC 45° female wire nut 74° fl.	37
72MS5	Maschio metrico DKOS 24°- Metric male S type 24° fl.	38
72FS5	Femm. metrica DKOS 24°- Metric female DKOS 24° fl.	38
72NS5	F.90° metrica DKOS 24°- 90°Metric female DKOS 24°	38
72QS5	F.45° metrica DKOS 24°- 45°Metric female DKOS 24°	39
72MN5	Maschio NPTF sv.60°- NPTF male 60° flare	39
72FH5	Femmina ORFS - ORFS female	40
72NH5	Femmina 90° ORFS - 90° ORFS female	40
72QH5	Femmina 45° ORFS - 45° ORFS female	40
72FL35	Flangia diritta SAE 3000 - Straight flange SAE 3000	41
72FLN35	Flangia 90° SAE 3000 - 90° flange SAE 3000	41
72FLQ35	Flangia 45° SAE 3000 - 45° flange SAE 3000	41
72FL65	Flangia diritta SAE 6000 - Straight flange SAE 6000	42
72FLN65	Flangia 90° SAE 6000 - 90° flange SAE 6000	42
72FLQ65	Flangia 45° SAE 6000 - 45° flange SAE 6000	42
72FL95	Flangia diritta SUPERCAT-Straight flange SUPERCAT	43
72FLN95	Flangia 90° SUPERCAT- 90° flange SUPERCAT	43
72FLQ95	Flangia 45° SUPERCAT - 45° flange SUPERCAT	43
part ref.	Raccordi Waterblast - Waterblast Fittings	Pag.
71745	Boccola 4 spirali - Ferrule 4 spirals	44
71765	Boccola 6 spirali - Ferrule 6 spirals	44
72FWS5	Femm. metrica DKOS 24°- Metric female DKOS 24° fl.	45
72MW	Maschio NPTF sv.60°- NPTF male 60° flare	45
72FW5	Femm. BSPP spinata - BSPP female wire nut	45
	Avvertenze per l'utilizzo	46

7176

BOCCOLA NO SKIVE S-7600 NO SKIVE FERRULE S-7600

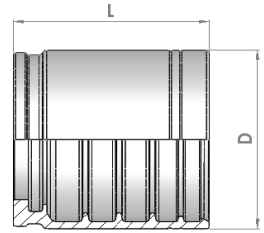

part ref.	Hose ID		Hose type	Dimension (mm)		Weight Kg
	[in]	size		Ext D	Length L	
717603	3/16"	03	1SN-2SN-2SC-R16	20	26	0,022
717604	1/4"	04	1SN-2SN-2SC-R16	22	28	0,027
717605	5/16"	05	1SN-2SN-2SC-R16	24	28	0,031
717606	3/8"	06	1SN-2SN-2SC-R16	26	28	0,035
717608	1/2"	08	1SN-2SN-2SC-R16	30	31	0,046
717610	5/8"	10	1SN-2SN-2SC-R16	33	31	0,047
717612	3/4"	12	1SN-2SN-2SC-R16	37	38	0,069
717616	1"	16	1SN-2SN-2SC-R16	46	47,5	0,114
717620	1.1/4"	20	1SN-2SN-2SC-R16	58	55	0,220
717624	1.1/2"	24	1SN-2SN	65	60	0,260
717632	2"	32	1SN-2SN	78	72	0,390
717640	2.1/2"	40	1SN-2SN	95	72	0,592
717648	3"	48	1SN-2SN	110	80	0,880

7172

BOCCOLA NO SKIVE S-7200 NO SKIVE FERRULE S-7200

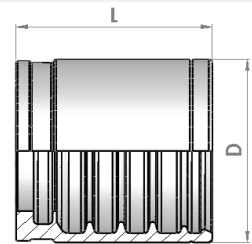

part ref.	Hose ID		Hose type	Dimension (mm)		Weight Kg
	[in]	size		Ext D	Length L	
717204	1/4"	04	1SN-1SC-2SC-R16-R17	20	26	0,021
717205	5/16"	05	1SN-1SC-2SC-R16-R17	22	26	0,023
717206	3/8"	06	1SN-1SC-2SC-R16-R17	24	26	0,025
717208	1/2"	08	1SN-1SC-2SC-R16	28	28	0,040
717210	5/8"	10	1SN-1SC-2SC-R16	32	29	0,047
717212	3/4"	12	1SN-1SC-2SC-R16	35	35	0,060
717216	1"	16	1SN-1SC-2SC-R16	44	44	0,107

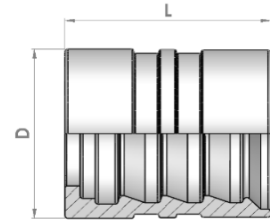
7155
BOCCOLA SKIVE S-5500
SKIVE FERRULE S-5500

part ref.	Hose ID		Hose type	Dimension (mm)		Weight Kg
	[in]	size		Ext D	Length L	
715504	1/4"	04	2ST-R2A-4SP	21,5	30	0,035
715506	3/8"	06	2ST-R2A-4SP-R12	26	32	0,053
715508	1/2"	08	2ST-R2A-4SP-R12	30	34	0,065
715510	5/8"	10	2ST-R2A-4SP-R12	34	38	0,083
715512	3/4"	12	2ST-R2A-4SP-4SH-R12	38	43	0,117
715516	1"	16	2ST-R2A-4SP-4SH-R12	46	56	0,208
715520	1.1/4"	20	2ST-R2A-4SP-4SH-R12	57	60	0,278
715524	1.1/2"	24	2ST-R2A-4SP-4SH-R12	65	70	0,378
715532	2"	32	2ST-R2A-4SP-4SH	79	79	0,532

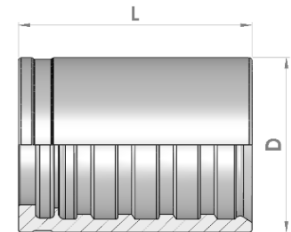
71116
BOCCOLA S-1160
FERRULE S-1160

part ref.	Hose ID		Hose type	Dimension (mm)		Weight Kg
	[in]	size		Ext D	Length L	
7111603	3/16"	03	R7-R8-MTH1	15	26	0,016
7111604	1/4"	04	R7-R8-MTH1	18	29	0,023
7111605	5/16"	05	R7-R8-MTH1	20	30	0,026
7111606	3/8"	06	R7-R8-MTH1	22	32	0,033
7111608	1/2"	08	R7-R8-MTH1	27	34	0,036

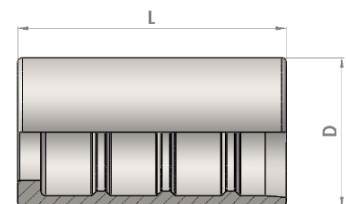
71110
BOCCOLA S-1100
FERRULE S-1100

part ref.	Hose ID		Hose type	Dimension (mm)		Weight Kg
	[in]	size		Ext D	Length L	
7111003	3/16"	03	R7	14	27	0,012
7111004	1/4"	04	R7-R6	17	29	0,015
7111005	5/16"	05	R7-R6-2TE	19	30	0,019
7111006	3/8"	06	R7-R6	21	31	0,026
7111008	1/2"	08	R7-R6-2TE	25,4	34	0,038
7111010	5/8"	10	R7-R6	28,5	36	0,043
7111012	3/4"	12	R7-R6-2TE	32	36	0,047
7111016	1"	16	R7-R6	40	50	0,109

71118 **BOCCOLA S-1180**
FERRULE S-1180

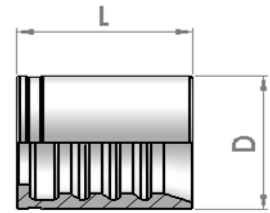

part ref.	Hose ID		Hose type	Dimension (mm)		Weight Kg
	[in]	size		Ext D	Length L	
7111808	1/2"	08	JC7-JC8	30	34	0,065
7111810	5/8"	10	JC7	34	36	0,100
7111812	3/4"	12	JC7-JC8	38	43	0,115
7111816	1"	16	JC7-JC8	46	58	0,212
7111820	1.1/4"	20	JC7-JC8	56	65	0,340

71120 **BOCCOLA S-1200**
FERRULE S-1200

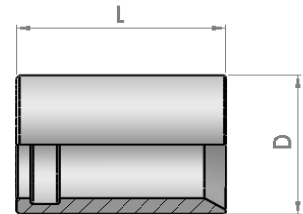

part ref.	Hose ID		Hose type	Dimension (mm)		Weight Kg
	[in]	size		Ext D	Length L	
7112003	3/16"	03	PTFE	14	26	0,014
7112004	1/4"	04	PTFE	15	30	0,021
7112005	5/16"	05	PTFE	17	30	0,028
7112006	3/8"	06	PTFE	19	32	0,025
7112008	1/2"	08	PTFE	24	34	0,045
7112010	5/8"	10	PTFE	28	37	0,053
7112012	3/4"	12	PTFE	30	41	0,059
7112016	1"	16	PTFE	38	45	0,110

72MG

MASCHIO BSPP CILINDRICO SV.60° BSPP PARALLEL MALE 60° FLARE

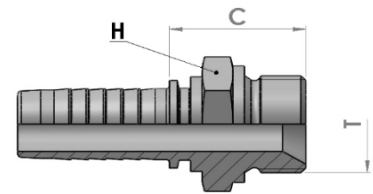

part ref.	Hose ID		Thread	Dimension (mm)			Weight Kg
	[in]	size		hex H	Cut-off C		
72MG0203	3/16"	03	1/8-28	14	21		0,015
72MG0403	3/16"	03	1/4-19	19	26		0,029
72MG0204	1/4"	04	1/8-28	14	21		0,018
72MG0404	1/4"	04	1/4-19	19	27		0,032
72MG0604	1/4"	04	3/8-19	22	28		0,047
72MG0804	1/4"	04	1/2-14	27	32		0,070
72MG0405	5/16"	05	1/4-19	19	27		0,034
72MG0605	5/16"	05	3/8-19	22	28		0,050
72MG0805	5/16"	05	1/2-14	27	32		0,073
72MG0406	3/8"	06	1/4-19	19	27		0,040
72MG0606	3/8"	06	3/8-19	22	29		0,051
72MG0806	3/8"	06	1/2-14	27	32		0,076
72MG0608	1/2"	08	3/8-19	22	29		0,060
72MG0808	1/2"	08	1/2-14	27	33		0,089
72MG1008	1/2"	08	5/8-14	30	34		0,100
72MG1208	1/2"	08	3/4-14	32	35		0,123
72MG0810	5/8"	10	1/2-14	27	33		0,097
72MG1010	5/8"	10	5/8-14	30	34		0,120
72MG1210	5/8"	10	3/4-14	32	35		0,130
72MG0812	3/4"	12	1/2-14	27	34		0,118
72MG1212	3/4"	12	3/4-14	32	36		0,141
72MG1612	3/4"	12	1-11	41	39		0,210
72MG1616	1"	16	1-11	41	40		0,280
72MG2016	1"	16	1.1/4-11	50	44		0,339
72MG2020	1.1/4"	20	1.1/4-11	50	45		0,434
72MG2420	1.1/4"	20	1.1/2-11	55	46		0,460
72MG2424	1.1/2"	24	1.1/2-11	55	46		0,514
72MG3224	1.1/2"	24	2-11	70	53		0,862
72MG3232	2"	32	2-11	70	53		0,935
72MG4040	2.1/2"	40	2.1/2-11	85	52		1,413
72MG4848	3"	48	3-11	100	52		2,180

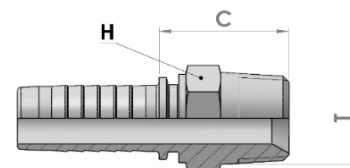
72MC
MASCHIO BSPT CONICO SV.60°
BSPT TAPARED MALE 60° FLARE

part ref.	Hose ID		Thread	Dimension (mm)			Weight Kg
	[in]	size		hex H	Cut-off C		
72MC0203	3/16"	03	1/8-28	12	22	0,013	
72MC0403	3/16"	03	1/4-19	15	27	0,019	
72MC0204	1/4"	04	1/8-28	12	23	0,016	
72MC0404	1/4"	04	1/4-19	15	28	0,028	
72MC0604	1/4"	04	3/8-19	19	28	0,038	
72MC0405	5/16"	05	1/4-19	15	28	0,038	
72MC0605	5/16"	05	3/8-19	19	28	0,041	
72MC0406	3/8"	06	1/4-19	15	28	0,033	
72MC0606	3/8"	06	3/8-19	19	28	0,043	
72MC0806	3/8"	06	1/2-14	22	33	0,067	
72MC0608	1/2"	08	3/8-19	19	29	0,055	
72MC0808	1/2"	08	1/2-14	22	34	0,078	
72MC1208	1/2"	08	3/4-14	27	36	0,115	
72MC0810	5/8"	10	1/2-14	22	34	0,085	
72MC1210	5/8"	10	3/4-14	27	36	0,127	
72MC1212	3/4"	12	3/4-14	27	37	0,127	
72MC1612	3/4"	12	1-11	36	43	0,220	
72MC1616	1"	16	1-11	36	44	0,260	
72MC2016	1"	16	1.1/4-11	46	46	0,350	
72MC2020	1.1/4"	20	1.1/4-11	46	47	0,417	
72MC2420	1.1/4"	20	1.1/2-11	50	49	0,480	
72MC2424	1.1/2"	24	1.1/2-11	50	49	0,537	
72MC3224	1.1/2"	24	2-11	65	55	0,880	
72MC3232	2"	32	2-11	65	55	0,911	

72FG

FEMMINA DIRITTA BSPP SV.60° BSPP STRAIGHT FEMALE 60° FLARE

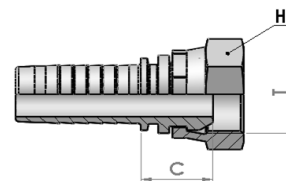

part ref.	Hose ID		Thread T	Dimension (mm)			Weight Kg
	[in]	size		hex H	Cut-off C		
72FG0203	3/16"	03	1/8-28	14	16		0,019
72FG0403	3/16"	03	1/4-19	19	18		0,028
72FG0603	3/16"	03	3/8-19	22	20		0,051
72FG0204	1/4"	04	1/8-28	14	16		0,018
72FG0404	1/4"	04	1/4-19	19	18		0,031
72FG0604	1/4"	04	3/8-19	22	20		0,043
72FG0804	1/4"	04	1/2-14	27	22		0,069
72FG0405	5/16"	05	1/4-19	19	18		0,033
72FG0605	5/16"	05	3/8-19	22	20		0,040
72FG0805	5/16"	05	1/2-14	27	22		0,070
72FG0406	3/8"	06	1/4-19	19	18		0,037
72FG0606	3/8"	06	3/8-19	22	20		0,047
72FG0806	3/8"	06	1/2-14	27	22		0,072
72FG0608	1/2"	08	3/8-19	22	20		0,067
72FG0808	1/2"	08	1/2-14	27	23		0,078
72FG1008	1/2"	08	5/8-14	30	23		0,090
72FG1208	1/2"	08	3/4-14	32	22		0,113
72FG0810	5/8"	10	1/2-14	27	23		0,095
72FG1010	5/8"	10	5/8-14	30	22		0,095
72FG1210	5/8"	10	3/4-14	32	22		0,116
72FG1212	3/4"	12	3/4-14	32	23		0,132
72FG1612	3/4"	12	1-11	38	25		0,166
72FG1616	1"	16	1-11	38	26		0,222

72NG

FEMMINA 90° BSPP SV.60° BSPP 90° FEMALE 60° FLARE

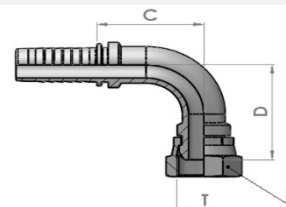

part ref.	Hose ID		Thread T	Dimension (mm)			Weight Kg
	[in]	size		hex H	Cut-off C	Drop D	
72NG0203	3/16"	03	1/8-28	14	22	24	0,023
72NG0403	3/16"	03	1/4-19	19	23	28	0,036
72NG0404	1/4"	04	1/4-19	19	25	28	0,430
72NG0604	1/4"	04	3/8-19	22	25	31	0,058
72NG0605	5/16"	05	3/8-19	22	29	36	0,065
72NG0606	3/8"	06	3/8-19	22	33	35	0,069
72NG0806	3/8"	06	1/2-14	27	33	37	0,099
72NG0608	1/2"	08	3/8-19	22	39	41	0,106
72NG0808	1/2"	08	1/2-14	27	39	41	0,127
72NG1008	1/2"	08	5/8-14	30	39	44	0,145
72NG1208	1/2"	08	3/4-14	32	39	44	0,168
72NG1010	5/8"	10	5/8-14	30	45	49	0,162
72NG1210	5/8"	10	3/4-14	32	45	51	0,188
72NG1212	3/4"	12	3/4-14	32	56	54	0,237
72NG1612	3/4"	12	1-11	38	56	58	0,296
72NG1616	1"	16	1-11	38	70	65	0,418

72QG

FEMMINA 45° BSPP SV.60° BSPP 45° FEMALE 60° FLARE

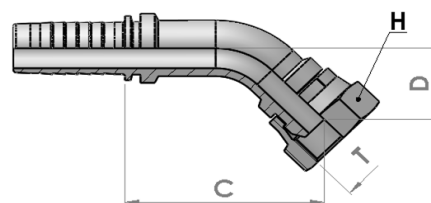

part ref.	Hose ID		Thread	Dimension (mm)				Weight Kg
	[in]	size		T	hex H	Cut-off C	Drop D	
72QG0203	3/16"	03	1/8-28	14	34	16	0,021	
72QG0403	3/16"	03	1/4-19	19	39	16	0,036	
72QG0404	1/4"	04	1/4-19	19	35	16	0,041	
72QG0604	1/4"	04	3/8-19	22	43	18	0,056	
72QG0605	5/16"	05	3/8-19	22	50	19	0,061	
72QG0606	3/8"	06	3/8-19	22	43	19	0,068	
72QG0806	3/8"	06	1/2-14	27	53	20	0,092	
72QG0808	1/2"	08	1/2-14	27	50	23	0,117	
72QG1008	1/2"	08	5/8-14	30	65	24	0,137	
72QG1208	1/2"	08	3/4-14	32	65	23	0,156	
72QG1010	5/8"	10	5/8-14	30	60	26	0,142	
72QG1210	5/8"	10	3/4-14	32	70	26	0,180	
72QG1212	3/4"	12	3/4-14	32	84	27	0,220	
72QG1612	3/4"	12	1-11	38	87	30	0,320	
72QG1616	1"	16	1-11	38	84	35	0,374	

72FGS

FEMMINA DIRITTA BSPP SPINATA SV.60° CON O-RING BSPP O-RING STRAIGHT FEMALE 60° FLARE THRUST WIRE NUT

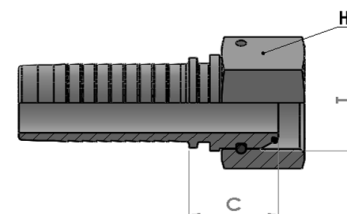

part ref.	Hose ID		Thread	Dimension (mm)				Weight Kg
	[in]	size		T	hex H	Cut-off C		
72FGS1212	3/4"	12	3/4-14	32	26		0,156	
72FGS1612	3/4"	12	1-11	38	27		0,190	
72FGS1616	1"	16	1-11	38	28		0,244	
72FG2016	1"	16	1.1/4-11	50	30		0,413	
72FG2020	1.1/4"	20	1.1/4-11	50	32		0,452	
72FG2420	1.1/4"	20	1.1/2-11	55	34		0,523	
72FG2424	1.1/2"	24	1.1/2-11	55	34		0,575	
72FG3224	1.1/2"	24	2-11	70	31		0,856	
72FG3232	2"	32	2-11	70	31		0,930	
72FG4040*	2.1/2"	40	2.1/2-11	85	36		1,596	
72FG4848*	3"	48	3-11	100	40		2,145	

*SENZA O-RING

*WITHOUT O-RING

72NGS

FEMMINA 90° BSPP SPINATA
SV.60° CON O-RING
BSPP O-RING 90° FEMALE 60° FLARE THRUST
WIRE NUT

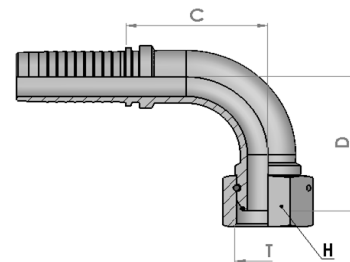

part ref.	Hose ID		Thread	Dimension (mm)				Weight Kg
	[in]	size		hex T	hex H	Cut-off C	Drop D	
72NGS1212	3/4"	12	3/4-14	32	56	54	0,257	
72NGS1612	3/4"	12	1-11	38	56	58	0,313	
72NGS1616	1"	16	1-11	38	70	65	0,448	
72NG2020	1.1/4"	20	1.1/4-11	50	85	86	0,692	
72NG2424	1.1/2"	24	1.1/2-11	55	99	100	1,156	
72NG3232	2"	32	2-11	70	128	127	2,174	
72NG4040*	2.1/2"	40	2.1/2-11	85	94	103	3,000	
72NG4848*	3"	48	3-11	100	117	128	3,950	

*SENZA O-RING / *WITHOUT O-RING

72QGS

FEMMINA 45° BSPP SPINATA
SV.60° CON O-RING
BSPP O-RING 45° FEMALE 60° FLARE THRUST
WIRE NUT

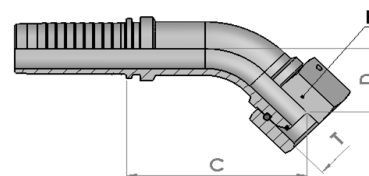

part ref.	Hose ID		Thread	Dimension (mm)				Weight Kg
	[in]	size		hex T	hex H	Cut-off C	Drop D	
72QGS1212	3/4"	12	3/4-14	32	84	27	0,239	
72QGS1612	3/4"	12	1-11	38	84	30	0,313	
72QGS1616	1"	16	1-11	38	84	35	0,404	
72QG2020	1.1/4"	20	1.1/4-11	50	103	50	0,693	
72QG2424	1.1/2"	24	1.1/2-11	55	116	55	1,045	
72QG3232	2"	32	2-11	70	143	70	2,030	
72QG4040*	2.1/2"	40	2.1/2-11	85	100	47	3,000	
72QG4848*	3"	48	3-11	100	123	57	3,950	

*SENZA O-RING / *WITHOUT O-RING

72FGO

FEMMINA DIRITTA BSPP SV.60° CON O-RING
BSPP STRAIGHT FEMALE 60° FLARE WITH O-RING

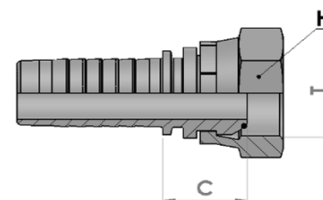

part ref.	Hose ID		Thread	Dimension (mm)			Weight Kg
	[in]	size		hex T	hex H	Cut-off C	
72FGO0404	1/4"	04	1/4-19	19	17	0,042	
72FGO0606	3/8"	06	3/8-19	22	20	0,047	
72FGO0808	1/2"	08	1/2-14	27	21	0,081	

72NGO

FEMMINA 90° BSPP SV.60° CON O-RING BSPP 90° FEMALE 60° FLARE WITH O-RING

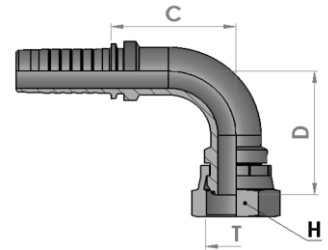

part ref.	Hose ID		Thread	Dimension (mm)				Weight Kg
	[in]	size		hex H	Cut-off C	Drop D	T	
72NGO0404	1/4"	04	1/4-19	19	28	26		0,043
72NGO0606	3/8"	06	3/8-19	22	31	31		0,073
72NGO0808	1/2"	08	1/2-14	27	41	34		0,127

72NGK

FEMMINA COMPATTA 90° BSPP SV.60° BSPP COMPACT 90° FEMALE 60° FLARE

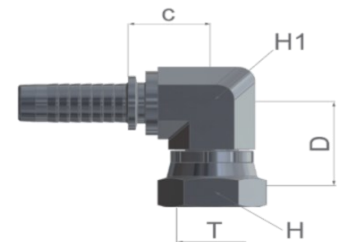

part ref.	Hose ID		Thread	Dimension (mm)				Weight Kg
	[in]	size		hex H	Cut-off C	Drop D	hex H1	
72NGK0404	1/4"	04	1/4-19	19	18	20,6	14	0,054
72NGK0606	3/8"	06	3/8-19	22	20	24	17	0,100
72NGK0808	1/2"	08	1/2-14	27	25	29,5	22	0,140
72NGK1212	3/4"	12	3/4-14	32	30,5	31	27	0,260
72NGK1616	1"	16	1-11	38	36	35	32	0,470

72OG

OCCHIO BSPP BSPP BANJO

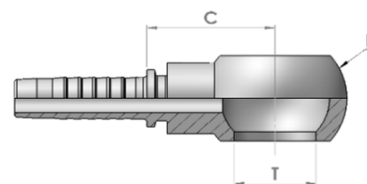

part ref.	Hose ID		Dimension (mm)				Weight
	[in]	size	Size T	Ball B	Cut-off C		Kg
72OG0203	3/16"	03	1/8"	10,1	17	19	0,014
72OG0403	3/16"	03	1/4"	13,3	24	26	0,033
72OG0204	1/4"	04	1/8"	10,1	17	25	0,016
72OG0404	1/4"	04	1/4"	13,3	24	26	0,035
72OG0604	1/4"	04	3/8"	16,8	28	26	0,040
72OG0405	5/16"	05	1/4"	13,3	24	26	0,040
72OG0605	5/16"	05	3/8"	16,8	28	26	0,049
72OG0406	3/8"	06	1/4"	13,3	24	29	0,040
72OG0606	3/8"	06	3/8"	16,8	28	26	0,048
72OG0806	3/8"	06	1/2"	21,1	36	31	0,103
72OG0608	1/2"	08	3/8"	16,8	28	27	0,050
72OG0808	1/2"	08	1/2"	21,1	36	31	0,114
72OG1208	1/2"	08	3/4"	26,6	45	38	0,171
72OG1010	5/8"	10	5/8"	23,1	40	38	0,126
72OG1212	3/4"	12	3/4"	26,6	45	38	0,207
72OG1612	3/4"	12	1"	33,5	58	50	0,350
72OG1616	1"	16	1"	33,5	58	51	0,406

74BFG

BULLONE FORATO BSPP BSPP BOLT

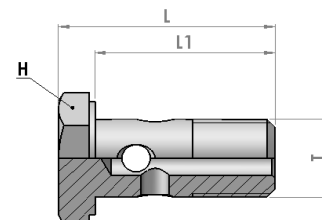

part ref.	Thread	Dimension (mm)			Weight
	T	hex H	L	L1	Kg
74BFG02	1/8-28	14	24	19,5	0,012
74BFG04	1/4-19	19	34,5	28,5	0,034
74BFG06	3/8-19	22	40,5	33	0,060
74BFG08	1/2-14	27	46	38	0,094
74BFG10	5/8-14	30	50	42	0,093
74BFG12	3/4-14	32	56	47	0,169
74BFG16	1-11	41	69	58	0,345

Le rondelle non sono comprese

The copper aren't included

72MJ

MASCHIO JIC SV.74° JIC MALE 74° FLARE

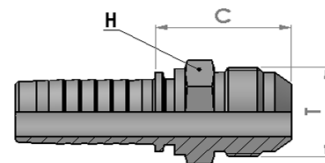

part ref.	Hose ID		Thread	Dimension (mm)		Weight Kg
	[in]	size		hex H	Cut-off C	
72MJ0403	3/16"	03	7/16-20	12	26	0,016
72MJ0404	1/4"	04	7/16-20	12	27	0,018
72MJ0504	1/4"	04	1/2-20	14	27	0,021
72MJ0604	1/4"	04	9/16-18	15	27	0,024
72MJ0605	5/16"	05	9/16-18	15	27	0,027
72MJ0606	3/8"	06	9/16-18	15	27	0,029
72MJ0806	3/8"	06	3/4-16	19	30	0,046
72MJ1006	3/8"	06	7/8-14	24	34	0,068
72MJ0808	1/2"	08	3/4-16	19	31	0,052
72MJ1008	1/2"	08	7/8-14	24	35	0,078
72MJ1208	1/2"	08	1.1/16-12	27	37	0,103
72MJ1010	5/8"	10	7/8-14	24	35	0,087
72MJ1210	5/8"	10	1.1/16-12	27	37	0,119
72MJ1012	3/4"	12	7/8-14	24	36	0,130
72MJ1212	3/4"	12	1.1/16-12	27	38	0,127
72MJ1412	3/4"	12	1.3/16-12	32	41	0,172
72MJ1612	3/4"	12	1.5/16-12	34	42	0,187
72MJ1216	1"	16	1.1/16-12	27	39	0,205
72MJ1616	1"	16	1.5/16-12	34	43	0,237
72MJ2016	1"	16	1.5/8-12	42	46	0,338
72MJ2020	1.1/4"	20	1.5/8-12	42	47	0,376
72MJ2420	1.1/4"	20	1.7/8-12	50	52	0,477
72MJ2424	1.1/2"	24	1.7/8-12	50	52	0,532
72MJ3232	2"	32	2.1/2-12	65	62	1,015

72FJ

FEMMINA DIRITTA JIC SV.74° JIC STRAIGHT FEMALE 74° FLARE

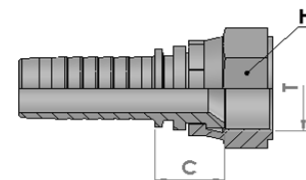

part ref.	Hose ID		Thread	Dimension (mm)		Weight Kg
	[in]	size		hex H	Cut-off C	
72FJ0403	3/16"	03	7/16-20	15	13	0,016
72FJ0404	1/4"	04	7/16-20	15	13	0,019
72FJ0504	1/4"	04	1/2-20	17	15	0,025
72FJ0604	1/4"	04	9/16-18	19	16	0,031
72FJ0505	5/16"	05	1/2-20	17	15	0,033
72FJ0605	5/16"	05	9/16-18	19	16	0,034
72FJ0606	3/8"	06	9/16-18	19	16	0,035
72FJ0806	3/8"	06	3/4-16	24	16	0,052
72FJ0808	1/2"	08	3/4-16	24	17	0,062
72FJ1008	1/2"	08	7/8-14	27	19	0,083
72FJ1208	1/2"	08	1.1/16-12	32	19	0,109
72FJ1010	5/8"	10	7/8-14	27	19	0,092
72FJ1210	5/8"	10	1.1/16-12	32	19	0,112
72FJ1212	3/4"	12	1.1/16-12	32	20	0,125
72FJ1412	3/4"	12	1.3/16-12	36	21	0,158
72FJ1612	3/4"	12	1.5/16-12	38	21	0,157
72FJ1616	1"	16	1.5/16-12	38	22	0,208

72NJ

FEMMINA 90° JIC SV.74° JIC 90° FEMALE 74° FLARE

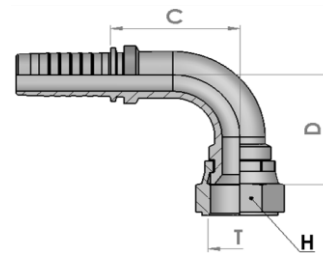

part ref.	Hose ID		Thread	Dimension (mm)				Weight Kg
	[in]	size		hex T	hex H	Cut-off C	Drop D	
72NJ0403	3/16"	03	7/16-20	15	22	22	0,024	
72NJ0404	1/4"	04	7/16-20	15	25	24	0,031	
72NJ0504	1/4"	04	1/2-20	17	25	25	0,040	
72NJ0604	1/4"	04	9/16-18	19	27	26	0,045	
72NJ0605	5/16"	05	9/16-18	19	30	31	0,053	
72NJ0606	3/8"	06	9/16-18	19	33	32	0,059	
72NJ0806	3/8"	06	3/4-16	24	33	33	0,092	
72NJ0808	1/2"	08	3/4-16	24	39	38	0,108	
72NJ1008	1/2"	08	7/8-14	27	42	42	0,130	
72NJ1208	1/2"	08	1.1/16-12	32	39	42	0,160	
72NJ1010	5/8"	10	7/8-14	27	45	45	0,165	
72NJ1210	5/8"	10	1.1/16-12	32	45	45	0,197	
72NJ1212	3/4"	12	1.1/16-12	32	56	52	0,233	
72NJ1412	3/4"	12	1.3/16-12	36	56	53	0,291	
72NJ1612	3/4"	12	1.5/16-12	38	57	56	0,317	
72NJ1616	1"	16	1.5/16-12	38	70	65	0,452	

72QJ

FEMMINA 45° JIC SV.74° JIC 45° FEMALE 74° FLARE

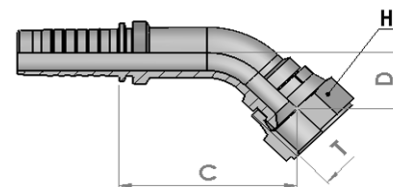

part ref.	Hose ID		Thread	Dimension (mm)				Weight Kg
	[in]	size		hex T	hex H	Cut-off C	Drop D	
72QJ0403	3/16"	03	7/16-20	15	33	14	0,026	
72QJ0404	1/4"	04	7/16-20	15	34	13	0,029	
72QJ0504	1/4"	04	1/2-20	17	40	13	0,036	
72QJ0604	1/4"	04	9/16-18	19	40	15	0,043	
72QJ0605	5/16"	05	9/16-18	19	47	16	0,047	
72QJ0606	3/8"	06	9/16-18	19	49	16	0,056	
72QJ0806	3/8"	06	3/4-16	24	51	18	0,075	
72QJ0808	1/2"	08	3/4-16	24	60	19	0,105	
72QJ1008	1/2"	08	7/8-14	27	63	20	0,120	
72QJ1208	1/2"	08	1.1/16-12	32	53	24	0,156	
72QJ1010	5/8"	10	7/8-14	27	68	24	0,142	
72QJ1210	5/8"	10	1.1/16-12	32	68	23	0,178	
72QJ1212	3/4"	12	1.1/16-12	32	69	27	0,202	
72QJ1412	3/4"	12	1.3/16-12	36	65	30	0,260	
72QJ1612	3/4"	12	1.5/16-12	38	72	30	0,278	
72QJ1616	1"	16	1.5/16-12	38	83	34	0,374	

72FJS

FEMMINA DIRITTA JIC SPINATA SV.74° JIC STRAIGHT FEMALE 74° FLARE THRUST WIRE NUT

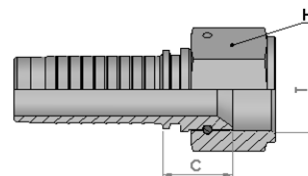

part ref.	Hose ID		Thread	Dimension (mm)			Weight Kg
	[in]	size		hex H	Cut-off C		
72FJ2016	1"	16	1.5/8-12	50	27		0,436
72FJ2020	1.1/4"	20	1.5/8-12	50	28		0,480
72FJ2420	1.1/4"	20	1.7/8-12	55	31		0,528
72FJ2424	1.1/2"	24	1.7/8-12	55	31		0,617
72FJ3232	2"	32	2.1/2-12	70	31		0,907

72NJS

FEMMINA 90° JIC SPINATA SV.74° JIC 90° FEMALE 74° FLARE THRUST WIRE NUT

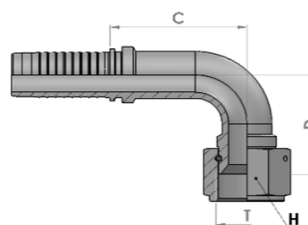

part ref.	Hose ID		Thread	Dimension (mm)			Weight Kg
	[in]	size		hex H	Cut-off C	Drop D	
72NJ2016	1"	16	1.5/8-12	50	70	72	0,600
72NJ2020	1.1/4"	20	1.5/8-12	50	85	88	0,850
72NJ2424	1.1/2"	24	1.7/8-12	55	99	101	1,350
72NJ3232	2"	32	2.1/2-12	70	125	132	2,250

72QJS

FEMMINA 45° JIC SPINATA SV.74° JIC 45° FEMALE 74° FLARE THRUST WIRE NUT

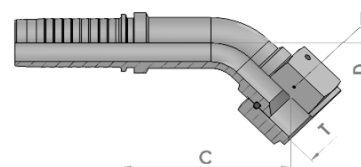

part ref.	Hose ID		Thread	Dimension (mm)			Weight Kg
	[in]	size		hex H	Cut-off C	Drop D	
72QJ2016	1"	16	1.5/8-12	50	87	40	0,580
72QJ2020	1.1/4"	20	1.5/8-12	50	105	52	0,780
72QJ2424	1.1/2"	24	1.7/8-12	55	138	58	1,270
72QJ3232	2"	32	2.1/2-12	70	167	77	2,100

72ML

MASCHIO METRICO SV.24° DKOL LEGGERO METRIC MALE 24° FLARE L TYPE

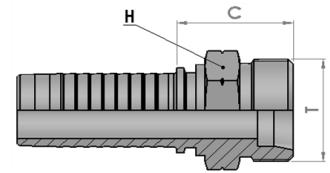

part ref.	Hose ID		Thread T	Dimension (mm)			Weight Kg
	[in]	size		hex H	Tube	Cut-off C	
72ML1203	3/16"	03	M12-1,5	14	6	22	0,014
72ML1204	1/4"	04	M12-1,5	14	6	23	0,016
72ML1404	1/4"	04	M14-1,5	15	8	22	0,018
72ML1604	1/4"	04	M16-1,5	17	10	23	0,024
72ML1804	1/4"	04	M18-1,5	19	12	24	0,028
72ML1605	5/16"	05	M16-1,5	17	10	23	0,028
72ML1805	5/16"	05	M18-1,5	19	12	24	0,030
72ML1606	3/8"	06	M16-1,5	17	10	23	0,031
72ML1806	3/8"	06	M18-1,5	19	12	24	0,034
72ML2206	3/8"	06	M22-1,5	22	15	25	0,054
72ML1808	1/2"	08	M18-1,5	19	12	25	0,046
72ML2208	1/2"	08	M22-1,5	22	15	26	0,056
72ML2608	1/2"	08	M26-1,5	27	18	27	0,082
72ML2610	5/8"	10	M26-1,5	27	18	27	0,085
72ML2612	3/4"	12	M26-1,5	27	18	28	0,107
72ML3012	3/4"	12	M30-2	30	22	33	0,124
72ML3616	1"	16	M36-2	36	28	32	0,200
72ML4520	1.1/4"	20	M45-2	46	35	36	0,320
72ML5224	1.1/2"	24	M52-2	55	42	38	0,476

72FL

FEMMINA DIRITTA METRICA SV.24° DKOL METRIC STRAIGHT FEMALE 24° FLARE L TYPE

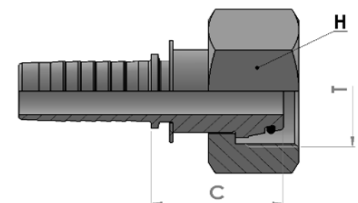

part ref.	Hose ID		Thread T	Dimension (mm)			Weight Kg
	hose ID [in]	size		hex H	Tube	Cut-off C	
72FL1203	3/16"	03	M12-1,5	14	6	23	0,018
72FL1204*	1/4"	04	M12-1,5	14	6	20	0,019
72FL1404	1/4"	04	M14-1,5	17	8	23	0,027
72FL1604	1/4"	04	M16-1,5	19	10	23	0,035
72FL1804	1/4"	04	M18-1,5	22	12	24	0,046
72FL1605	5/16"	05	M16-1,5	19	10	23	0,038
72FL1606*	3/8"	06	M16-1,5	19	10	25	0,035
72FL1806	3/8"	06	M18-1,5	22	12	23	0,050
72FL2206	3/8"	06	M22-1,5	27	15	28	0,079
72FL2208	1/2"	08	M22-1,5	27	15	28	0,084
72FL2610	5/8"	10	M26-1,5	32	18	29	0,126
72FL3012	3/4"	12	M30-2	36	22	29	0,172
72FL3616	1"	16	M36-2	41	28	30	0,255
72FL4520	1.1/4"	20	M45-2	50	35	40	0,437
72FL5224	1.1/2"	24	M52-2	60	42	41	0,619

*DADO PINZATO

*CRIMPED NUT

72NL

FEMMINA 90° METRICA SV.24° DKOL 90° METRIC FEMALE 24° FLARE L TYPE

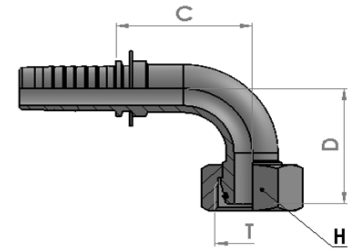

part ref.	Hose ID		Thread T	Dimension (mm)				Weight Kg
	[in]	size		hex H	Tube	Cut-off C	Drop D	
72NL1203	3/16"	03	M12-1,5	14	6	25	24	0,020
72NL1404	1/4"	04	M14-1,5	17	8	27	32	0,044
72NL1604	1/4"	04	M16-1,5	19	10	28	27	0,042
72NL1804	1/4"	04	M18-1,5	22	12	26	31	0,055
72NL1605	5/16"	05	M16-1,5	19	10	34	31	0,049
72NL1606	3/8"	06	M16-1,5	19	10	32	30	0,048
72NL1806	3/8"	06	M18-1,5	22	12	34	38	0,066
72NL2206	3/8"	06	M22-1,5	27	15	33	48	0,094
72NL2208	1/2"	08	M22-1,5	27	15	43	39	0,119
72NL2610	5/8"	10	M26-1,5	32	18	46	53	0,171
72NL2612	3/4"	12	M26-1,5	32	18	57	64	0,295
72NL3012	3/4"	12	M30-2	36	22	57	50	0,259
72NL3616	1"	16	M36-2	41	28	72	58	0,428
72NL4520	1.1/4"	20	M45-2	50	35	83	81	0,718
72NL5224	1.1/2"	24	M52-2	55	42	100	93	1,120

*DADO PINZATO

*CRIMPED NUT

72QL

FEMMINA 45° METRICA SV.24° DKOL 45° METRIC FEMALE 24° FLARE L TYPE

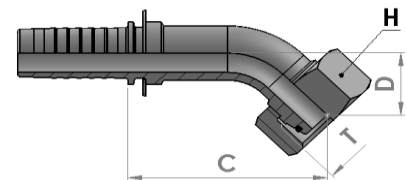

part ref.	Hose ID		Thread T	Dimension (mm)				Weight Kg
	[in]	size		hex H	Tube	Cut-off C	Drop D	
72QL1203	3/16"	03	M12-1,5	14	6	43	14	0,020
72QL1404	1/4"	04	M14-1,5	17	8	46	17	0,035
72QL1604	1/4"	04	M16-1,5	19	10	46	17	0,043
72QL1804	1/4"	04	M18-1,5	22	12	44	17	0,055
72QL1605	5/16"	05	M16-1,5	19	10	49	16	0,044
72QL1806	3/8"	06	M18-1,5	22	12	43	19	0,062
72QL2206	3/8"	06	M22-1,5	27	15	52	18	0,091
72QL2208	1/2"	08	M22-1,5	27	15	47	23	0,101
72QL2610	5/8"	10	M26-1,5	32	18	69	23	0,178
72QL2612	3/4"	12	M26-1,5	32	18	85	25	0,275
72QL3012	3/4"	12	M30-2	36	22	84	30	0,243
72QL3616	1"	16	M36-2	41	28	80	35	0,380
72QL4520	1.1/4"	20	M45-2	50	35	100	45	0,608
72QL5224	1.1/2"	24	M52-2	60	42	111	50	0,943

72MS

MASCHIO METRICO SV.24° DKOS PESANTE METRIC MALE 24° FLARE S TYPE

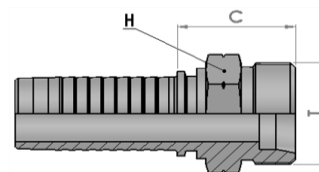

part ref.	Hose ID		Thread	Dimension (mm)			Weight Kg
	[in]	size		hex H	Tube	Cut-off C	
72MS1603	3/16"	03	M16-1,5	17	8	26	0,025
72MS1604	1/4"	04	M16-1,5	17	8	27	0,032
72MS1804	1/4"	04	M18-1,5	19	10	27	0,039
72MS2004	1/4"	04	M20-1,5	22	12	29	0,047
72MS2005	5/16"	05	M20-1,5	22	12	29	0,054
72MS1806	3/8"	06	M18-1,5	22	10	27	0,044
72MS2006	3/8"	06	M20-1,5	22	12	29	0,052
72MS2206	3/8"	06	M22-1,5	22	14	31	0,064
72MS2406	3/8"	06	M24-1,5	24	16	31	0,070
72MS2408	1/2"	08	M24-1,5	24	16	32	0,078
72MS3010	5/8"	10	M30-2	30	20	34	0,127
72MS3012	3/4"	12	M30-2	30	20	35	0,137
72MS3612	3/4"	12	M36-2	36	25	38	0,194
72MS3616	1"	16	M36-2	36	25	39	0,252
72MS4216	1"	16	M42-2	46	30	42	0,338
72MS4220	1.1/4"	20	M42-2	46	30	43	0,390
72MS5220	1.1/4"	20	M52-2	55	38	50	0,497
72MS5224	1.1/2"	24	M52-2	55	38	50	0,632

72FS

FEMMINA DIRITTA METRICA SV.24° DKOS METRIC STRAIGHT FEMALE 24° FLARE S TYPE

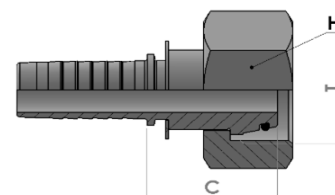

part ref.	Hose ID		Thread	Dimension (mm)			Weight Kg
	[in]	size		hex H	Tube	Cut-off C	
72FS1603	3/16"	03	M16-1,5	19	8	25	0,034
72FS1604	1/4"	04	M16-1,5	19	8	25	0,036
72FS1804	1/4"	04	M18-1,5	22	10	24	0,048
72FS1805	5/16"	05	M18-1,5	22	10	24	0,050
72FS2005	5/16"	05	M20-1,5	24	12	26	0,061
72FS1806	3/8"	06	M18-1,5	22	10	24	0,062
72FS2006	3/8"	06	M20-1,5	24	12	26	0,062
72FS2206	3/8"	06	M22-1,5	27	14	29	0,089
72FS2408	1/2"	08	M24-1,5	30	16	29	0,111
72FS3010	5/8"	10	M30-2	36	20	33	0,196
72FS3012	3/4"	12	M30-2	36	20	34	0,190
72FS3612	3/4"	12	M36-2	46	25	40	0,341
72FS3616	1"	16	M36-2	46	25	41	0,287
72FS4216	1"	16	M42-2	50	30	43	0,451
72FS5220	1.1/4"	20	M52-2	60	38	44	0,650
72FS5224	1.1/2"	24	M52-2	60	38	44	0,694

72NS

FEMMINA 90° METRICA SV.24° DKOS 90° METRIC FEMALE 24° FLARE S TYPE

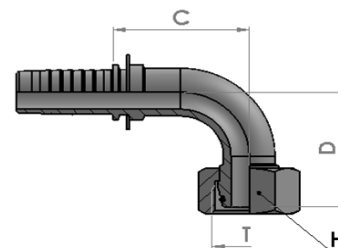

part ref.	Hose ID		Thread	Dimension (mm)				Weight Kg
	[in]	size		hex H	Tube	Cut-off C	Drop D	
72NS1603	3/16"	03	M16-1,5	19	8	25	26	0,038
72NS1604	1/4"	04	M16-1,5	19	8	26	28	0,042
72NS1804	1/4"	04	M18-1,5	22	10	27	30	0,059
72NS2005	5/16"	05	M20-1,5	24	12	31	35	0,072
72NS1806	3/8"	06	M18-1,5	22	10	34	34	0,070
72NS2006	3/8"	06	M20-1,5	24	12	34	34	0,081
72NS2206	3/8"	06	M22-1,5	27	14	33	36	0,100
72NS2408	1/2"	08	M24-1,5	30	16	41	42	0,146
72NS3010	5/8"	10	M30-2	36	20	46	50	0,225
72NS3012	3/4"	12	M30-2	36	20	58	55	0,277
72NS3612	3/4"	12	M36-2	46	25	56	59	0,404
72NS3616	1"	16	M36-2	46	25	72	66	0,536
72NS4216	1"	16	M42-2	50	30	72	66	0,578
72NS5220	1.1/4"	20	M52-2	60	38	86	86	0,970
72NS5224	1.1/2"	24	M52-2	60	38	100	94	1,200

72QS

FEMMINA 45° METRICA SV.24° DKOS 45° METRIC FEMALE 24° FLARE S TYPE

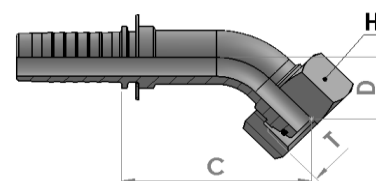

part ref.	Hose ID		Thread	Dimension (mm)				Weight Kg
	[in]	size		hex H	Tube	Cut-off C	Drop D	
72QS1603	3/16"	03	M16-1,5	19	8	35	16	0,038
72QS1604	1/4"	04	M16-1,5	19	8	46	15	0,040
72QS1804	1/4"	04	M18-1,5	22	10	47	18	0,053
72QS1805	5/16"	05	M18-1,5	22	10	43	19	0,055
72QS2005	5/16"	05	M20-1,5	24	12	42	19	0,065
72QS2006	3/8"	06	M20-1,5	24	12	59	17	0,070
72QS2206	3/8"	06	M22-1,5	27	14	57	19	0,096
72QS2408	1/2"	08	M24-1,5	30	16	63	20	0,132
72QS3010	5/8"	10	M30-2	36	20	73	27	0,221
72QS3012	3/4"	12	M30-2	36	20	73	30	0,278
72QS3612	3/4"	12	M36-2	46	25	72	32	0,400
72QS3616	1"	16	M36-2	46	25	87	40	0,506
72QS4216	1"	16	M42-2	50	30	84	35	0,580
72QS5220	1.1/4"	20	M52-2	60	38	105	50	0,903
72QS5224	1.1/2"	24	M52-2	60	38	115	48	1,155

72TD

ESTREMITA' TUBOLARE METRICA METRIC STANDPIPE

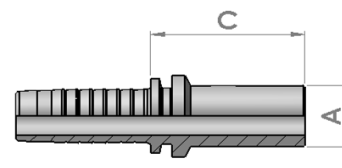

part ref.	Hose ID		Duty	Dimension (mm)			Weight Kg
	[in]	size		Tube A	Cut-off C		
72TD0603	3/16"	03	L/S	6	30		0,008
72TD0803	3/16"	03	L/S	8	29		0,010
72TD0604	1/4"	04	L	6	32		0,011
72TD0804	1/4"	04	L/S	8	29		0,013
72TD1004	1/4"	04	L/S	10	32		0,018
72TD1204	1/4"	04	L/S	12	30		0,020
72TD0805	5/16"	05	L/S	8	29		0,015
72TD1005	5/16"	05	L/S	10	30		0,019
72TD1205	5/16"	05	L/S	12	32		0,023
72TD1006	3/8"	06	L	10	31		0,022
72TD1206	3/8"	06	L/S	12	31		0,026
72TD1406	3/8"	06	S	14	36		0,039
72TD1506	3/8"	06	L	15	32		0,036
72TD1408	1/2"	08	S	14	37		0,047
72TD1508	1/2"	08	L	15	33		0,048
72TD1608	1/2"	08	S	16	38		0,058
72TD1808	1/2"	08	L	18	34		0,061
72TD1810	5/8"	10	L	18	34		0,066
72TD2010	5/8"	10	S	20	44		0,078
72TD2210	5/8"	10	L	22	36		0,071
72TD1812	3/4"	12	L	18	34		0,090
72TD2012	3/4"	12	S	20	45		0,094
72TD2212	3/4"	12	L	22	36		0,096
72TD2512	3/4"	12	S	25	49		0,120
72TD2516	1"	16	S	25	49		0,164
72TD2816	1"	16	L	28	39		0,188
72TD3016	1"	16	S	30	54		0,228
72TD3020	1.1/4"	20	S	30	55		0,281
72TD3520	1.1/4"	20	L	35	47		0,278
72TD3820	1.1/4"	20	S	38	61		0,326
72TD3824	1.1/2"	24	S	38	61		0,386
72TD4224	1.1/2"	24	L	42	49		0,375

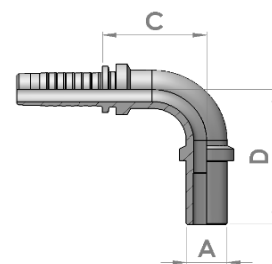
72TN
ESTREMITA' TUBOLARE METRICA 90°
METRIC STANDPIPE 90° ELBOW

part ref.	Hose ID		Duty	Dimension (mm)			Weight Kg
	[in]	size		Tube A	Cut-off C	Drop D	
72TN0603	3/16"	03	L/S	6	24	37	0,015
72TN0803	3/16"	03	L/S	8	24	41	0,030
72TN0604	1/4"	04	L	6	25	37	0,015
72TN0804	1/4"	04	L/S	8	25	39	0,024
72TN1004	1/4"	04	L/S	10	25	42	0,029
72TN1204	1/4"	04	L/S	12	25	44	0,037
72TN1005	5/16"	05	L/S	10	29	42	0,036
72TN1205	5/16"	05	L/S	12	29	44	0,040
72TN1006	3/8"	06	L	10	30	42	0,031
72TN1206	3/8"	06	L/S	12	30	45	0,043
72TN1406	3/8"	06	S	14	33	46	0,062
72TN1506	3/8"	06	L	15	38	53	0,050
72TN1408	1/2"	08	S	14	34	46	0,072
72TN1508	1/2"	08	L	15	39	53	0,071
72TN1608	1/2"	08	S	16	42	56	0,090
72TN1808	1/2"	08	L	18	42	56	0,100
72TN1810	5/8"	10	L	18	42	56	0,104
72TN2010	5/8"	10	S	20	47	65	0,120
72TN2210	5/8"	10	L	22	53	70	0,148
72TN2012	3/4"	12	S	20	48	65	0,145
72TN2212	3/4"	12	L	22	53	71	0,177
72TN2512	3/4"	12	S	25	56	75	0,160
72TN2516	1"	16	S	25	60	75	0,280
72TN2816	1"	16	L	28	67	89	0,285
72TN3016	1"	16	S	30	68	89	0,339
72TN3020	1.1/4"	20	S	30	67	89	0,423
72TN3520	1.1/4"	20	L	35	77	98	0,487
72TN3820	1.1/4"	20	S	38	81	102	0,737
72TN3824	1.1/2"	24	S	38	81	102	0,778
72TN4224	1.1/2"	24	L	42	91	125	0,675

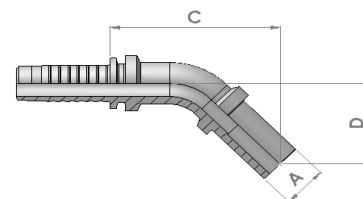
72TQ
ESTREMITA' TUBOLARE METRICA 45°
METRIC STANDPIPE 45° ELBOW

part ref.	Hose ID		Duty	Dimension (mm)			Weight
	[in]	size		Tube	Cut-off	Drop	
			Tipo	A	C	D	Kg
72TQ0603	3/16"	03	L/S	6	41	20	0,014
72TQ0803	3/16"	03	L/S	8	44	23	0,019
72TQ0604	1/4"	04	L	6	42	30	0,013
72TQ0804	1/4"	04	L/S	8	41	29	0,018
72TQ1004	1/4"	04	L/S	10	42	30	0,027
72TQ1204	1/4"	04	L/S	12	42	30	0,034
72TQ1005	5/16"	05	L/S	10	50	25	0,028
72TQ1205	5/16"	05	L/S	12	53	26	0,034
72TQ1006	3/8"	06	L	10	51	34	0,028
72TQ1206	3/8"	06	L/S	12	54	34	0,039
72TQ1406	3/8"	06	S	14	51	27	0,050
72TQ1506	3/8"	06	L	15	55	28	0,053
72TQ1408	1/2"	08	S	14	52	27	0,065
72TQ1508	1/2"	08	L	15	56	28	0,062
72TQ1608	1/2"	08	S	16	55	28	0,068
72TQ1808	1/2"	08	L	18	59	31	0,081
72TQ1810	5/8"	10	L	18	59	31	0,080
72TQ2010	5/8"	10	S	20	65	33	0,115
72TQ2210	5/8"	10	L	22	68	35	0,140
72TQ2012	3/4"	12	S	20	66	33	0,138
76TQ2212	3/4"	12	L	22	67	35	0,171
72TQ2512	3/4"	12	S	25	77	39	0,197
72TQ2516	1"	16	S	25	81	39	0,250
72TQ2816	1"	16	L	28	92	38	0,272
72TQ3016	1"	16	S	30	91	44	0,328
72TQ3020	1.1/4"	20	S	30	91	44	0,400
72TQ3520	1.1/4"	20	L	35	97	46	0,440
72TQ3820	1.1/4"	20	S	38	103	51	0,504
72TQ3824	1.1/2"	24	S	38	103	51	0,747
72TQ4224	1.1/2"	24	L	42	113	92	0,665

72MM

MASCHIO METRICO SV.60° METRIC MALE 60° FLARE

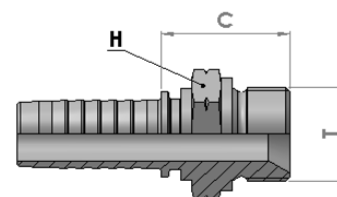

part ref.	Hose ID		Thread	Dimension (mm)			Weight Kg
	[in]	size		hex H	Cut-off C		
72MM1003	3/16"	03	M10-1	14	21		0,020
72MM1004	1/4"	04	M10-1	14	21		0,020
72MM1204	1/4"	04	M12-1,5	17	25		0,027
72MM1404	1/4"	04	M14-1,5	19	27		0,032
72MM1604	1/4"	04	M16-1,5	22	29		0,040
72MM1605	5/16"	05	M16-1,5	22	29		0,050
72MM1606	3/8"	06	M16-1,5	22	29		0,044
72MM1806	3/8"	06	M18-1,5	24	29		0,052
72MM2006	3/8"	06	M20-1,5	27	32		0,066
72MM2206	3/8"	06	M22-1,5	27	32		0,070
72MM1808	1/2"	08	M18-1,5	24	29		0,063
72MM2008	1/2"	08	M20-1,5	27	33		0,080
72MM2208	1/2"	08	M22-1,5	27	33		0,080
72MM2210	5/8"	10	M22-1,5	27	34		0,106
72MM2610	5/8"	10	M26-1,5	32	36		0,122
72MM2612	3/4"	12	M26-1,5	32	37		0,135
72MM3012	3/4"	12	M30-1,5	36	36		0,160
72MM3816	1"	16	M38-1,5	41	40		0,280

72FM

FEMMINA DIRITTA METRICA SV.60° METRIC STRAIGHT FEMALE 60° FLARE

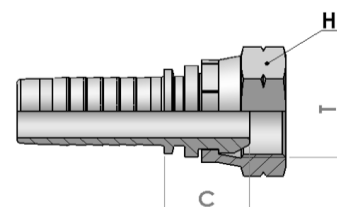

part ref.	Hose ID		Thread	Dimension (mm)			Weight Kg
	[in]	size		hex H	Cut-off C		
72FM1003	3/16"	03	M10-1	15	18		0,014
72FM1004	1/4"	04	M10-1	15	18		0,018
72FM1204	1/4"	04	M12-1,5	17	18		0,024
72FM1404	1/4"	04	M14-1,5	19	18		0,029
72FM1405	5/16"	05	M14-1,5	19	18		0,031
72FM1605	5/16"	05	M16-1,5	22	19		0,043
72FM1606	3/8"	06	M16-1,5	22	20		0,044
72FM1806	3/8"	06	M18-1,5	24	20		0,054
72FM1808	1/2"	08	M18-1,5	24	20		0,073
72FM2008	1/2"	08	M20-1,5	27	22		0,082
72FM2208	1/2"	08	M22-1,5	27	22		0,077
72FM2210	5/8"	10	M22-1,5	27	23		0,092
72FM2410	5/8"	10	M24-1,5	30	23		0,102
72FM2612	3/4"	12	M26-1,5	32	25		0,133
72FM3816	1"	16	M38-1,5	46	26		0,420
72FM4520	1.1/4"	20	M45-1,5	50	32		0,510

72NM

FEMMINA 90° METRICA SV.60° 90° METRIC FEMALE 60° FLARE

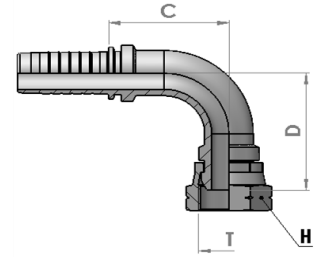

part ref.	Hose ID		Thread	Dimension (mm)			Weight Kg
	[in]	size		hex E	Cut-off C	Drop H	
72NM1003	3/16"	03	M10-1	15	23	29	0,024
72NM1004	1/4"	04	M10-1	15	23	29	0,028
72NM1204	1/4"	04	M12-1,5	17	23	29	0,043
72NM1404	1/4"	04	M14-1,5	19	23	29	0,041
72NM1405	5/16"	05	M14-1,5	19	31	33	0,051
72NM1605	5/16"	05	M16-1,5	22	31	35	0,063
72NM1606	3/8"	06	M16-1,5	22	33	38	0,071
72NM1806	3/8"	06	M18-1,5	24	33	38	0,076
72NM1808	1/2"	08	M18-1,5	24	39	43	0,097
72NM2008	1/2"	08	M20-1,5	27	39	45	0,131
72NM2208	1/2"	08	M22-1,5	27	39	45	0,123
72NM2210	5/8"	10	M22-1,5	27	49	54	0,152
72NM2610	5/8"	10	M26-1,5	32	49	56	0,190
72NM2612	3/4"	12	M26-1,5	32	53	59	0,218
72NM3816	1"	12	M38-1,5	46	70	65	0,650
72NM4520	1.1/4"	20	M45-1,5	50	93	89	0,780

72QM

FEMMINA 45° METRICA SV.60° 45° METRIC FEMALE 60° FLARE

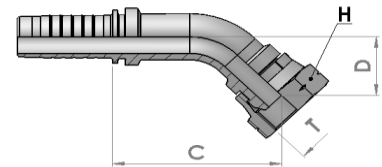

part ref.	Hose ID		Thread	Dimension (mm)			Weight Kg
	[in]	size		hex H	Cut-off C	Drop D	
72QM1003	3/16"	03	M10-1	15	40	17	0,022
72QM1204	1/4"	04	M12-1,5	17	40	17	0,043
72QM1404	1/4"	04	M14-1,5	19	40	17	0,041
72QM1605	5/16"	05	M16-1,5	22	43	20	0,064
72QM1806	3/8"	06	M18-1,5	24	55	20	0,075
72QM1808	1/2"	08	M18-1,5	24	65	23	0,114
72QM2008	1/2"	08	M20-1,5	27	65	23	0,119
72QM2208	1/2"	08	M22-1,5	27	65	23	0,114
72QM2210	5/8"	10	M22-1,5	27	64	25	0,159
72QM2612	3/4"	12	M26-1,5	32	63	29	0,224
72QM3816	1"	12	M38-1,5	46	84	35	0,630
72QM4520	1.1/4"	20	M45-1,5	50	103	45	0,790

72OM OCCHIO METRICO METRIC BANJO

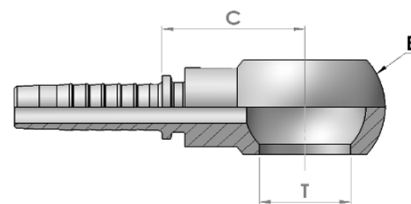

part ref.	Hose ID		Dimension (mm)				Weight
	[in]	size	Size T	Ball B	Cut-off C		Kg
72OM0803	3/16"	03	8	14	21		0,012
72OM1003	3/16"	03	10	17	19		0,014
72OM1004	1/4"	04	10	17	25		0,019
72OM1204	1/4"	04	12	20	27		0,024
72OM1404	1/4"	04	14	24	27		0,033
72OM1205	5/16"	05	12	20	22		0,023
72OM1405	5/16"	05	14	24	24		0,036
72OM1605	5/16"	05	16	28	26		0,049
72OM1805	5/16"	05	18	32	29		0,075
72OM1406	3/8"	06	14	24	25		0,039
72OM1606	3/8"	06	16	28	26		0,053
72OM1806	3/8"	06	18	32	29		0,074
72OM1808	1/2"	08	18	32	29		0,089
72OM2008	1/2"	08	20	36	31		0,097
72OM2208	1/2"	08	22	36	31		0,095
72OM2210	5/8"	10	22	36	31		0,100
72OM2612	3/4"	12	26	46	38		0,207
72OM3016	1"	16	30	54	43		0,377

74BFM BULLONE FORATO METRICO METRIC BOLT

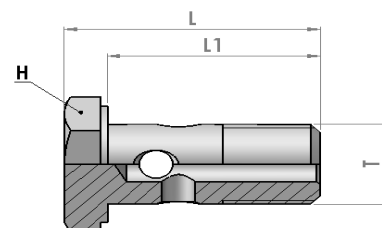

part ref.	Thread	Dimension (mm)			Weight
	T	hex H	L	L1	Kg
74BFM08	M8-1	12	21	16,0	0,010
74BFM10	M10-1	14	24	19,5	0,013
74BFM12	M12-1,5	17	31,5	25,5	0,025
74BFM14	M14-1,5	19	34	28,5	0,037
74BFM16	M16-1,5	22	41	33	0,060
74BFM18	M18-1,5	24	44,5	36,5	0,068
74BFM20	M20-1,5	27	46	38	0,090
74BFM22	M22-1,5	27	46	38	0,104
74BFM26	M26-1,5	32	56	45,5	0,172
74BFM30	M30-1,5	36	66	55	0,240

Le rondelle non sono comprese.

The copper aren't included.

72MH

MASCHIO ORFS ORFS MALE

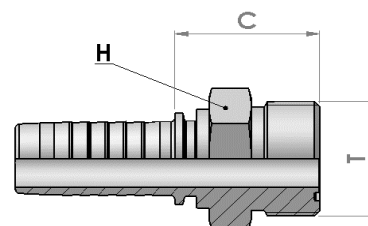

part ref.	Hose ID		Thread	Dimension (mm)			Weight Kg
	[in]	size		hex H	Cut-off C		
72MH0404	1/4"	04	9/16-18	15	23	0,030	
72MH0605	5/16"	05	11/16-16	19	26	0,055	
72MH0606	3/8"	06	11/16-16	19	26	0,060	
72MH0806	3/8"	06	13/16-16	22	29	0,076	
72MH0808	1/2"	08	13/16-16	22	29	0,080	
72MH1010	5/8"	10	1-14	27	33	0,116	
72MH1212	3/4"	12	1.3/16-12	32	36	0,160	
72MH1616	1"	16	1.7/16-12	38	37	0,266	
72MH2020	1.1/4"	20	1.11/16"-12	46	44	0,435	
72MH2424	1.1/2"	24	2-12	55	47	1,250	

72FH

FEMMINA DIRITTA ORFS STRAIGHT ORFS FEMALE

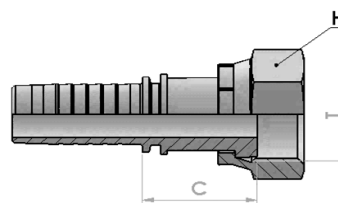

part ref.	Hose ID		Thread	Dimension (mm)			Weight Kg
	[in]	size		hex H	Cut-off C		
72FH0404	1/4"	04	9/16-18	17	24	0,028	
72FH0604	1/4"	04	11/16-16	22	24	0,048	
72FH0605	5/16"	05	11/16-16	22	24	0,058	
72FH0606	3/8"	06	11/16-16	22	24	0,053	
72FH0806	3/8"	06	13/16-16	24	30	0,081	
72FH0808	1/2"	08	13/16-16	24	30	0,078	
72FH1008	1/2"	08	1-14	30	33	0,120	
72FH1208	1/2"	08	1.3/16-12	36	33	0,180	
72FH1010	5/8"	10	1-14	30	33	0,140	
72FH1012	3/4"	12	1-14	30	33	0,180	
72FH1212	3/4"	12	1.3/16-12	36	34	0,200	
72FH1612	3/4"	12	1.7/16-12	41	36	0,260	
72FH1616	1"	16	1.7/16-12	41	37	0,320	
72FH2020	1.1/4"	20	1.11/16-12	50	40	0,380	
72FH2424	1.1/2"	24	2-12	60	41	0,670	

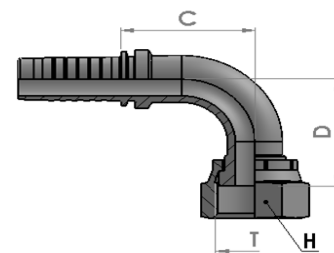

72NH **FEMMINA 90° ORFS**
90° ORFS FEMALE

part ref.	Hose ID		Thread	Dimension (mm)			Weight Kg
	[in]	size		hex H	Cut-off C	Drop D	
72NH0404	1/4"	04	9/16-18	17	26	24	0,034
72NH0604	1/4"	04	11/16-16	22	26	26	0,065
72NH0606	3/8"	06	11/16-16	22	35	28	0,070
72NH0806	3/8"	06	13/16-16	24	34	31	0,080
72NH0808	1/2"	08	13/16-16	24	40	37	0,085
72NH1008	1/2"	08	1-14	30	42	37	0,165
72NH1208	1/2"	08	1.3/16-12	36	42	37	0,180
72NH1010	5/8"	10	1-14	30	45	42	0,180
72NH1212	3/4"	12	1.3/16-12	36	52	48	0,280
72NH1616	1"	16	1.7/16-12	41	72	58	0,420
72NH2020	1.1/4"	20	1.11/16-12	50	83	74	0,645
72NH2424	1.1/2"	24	2-12	60	100	85	1,106

72QH **FEMMINA 45° ORFS**
45° ORFS FEMALE

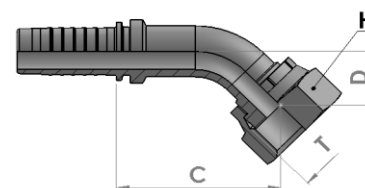

part ref.	Hose ID		Thread	Dimension (mm)			Weight Kg
	[in]	size		hex H	Cut-off C	Drop D	
72QH0404	1/4"	04	9/16-18	17	38	12	0,045
72QH0604	1/4"	04	11/16-16	22	40	14	0,065
72QH0606	3/8"	06	11/16-16	22	47	14	0,070
72QH0806	3/8"	06	13/16-16	24	47	16	0,080
72QH0808	1/2"	08	13/16-16	24	58	17	0,085
72QH1008	1/2"	08	1-14	30	60	17	0,145
72QH1208	1/2"	08	1.3/16-12	36	50	18	0,180
72QH1010	5/8"	10	1-14	30	64	20	0,180
72QH1212	3/4"	12	1.3/16-12	36	79	22	0,274
72QH1616	1"	16	1.7/16-12	41	77	25	0,420
72QH2020	1.1/4"	20	1.11/16-12	50	119	32	0,647
72QH2424	1.1/2"	24	2-12	60	142	39	1,106

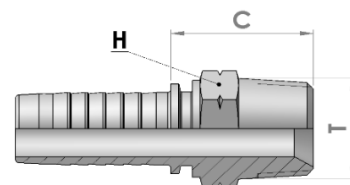
72MN
MASCHIO NPT SV.60°
NPT MALE 60° FLARE

part ref.	Hose ID		Thread	Dimension (mm)			Weight Kg
	[in]	size		hex H	Cut-off C		
72MN0203	3/16"	03	1/8-27	12	22	0,013	
72MN0403	3/16"	03	1/4-18	15	28	0,018	
72MN0204	1/4"	04	1/8-27	12	22	0,016	
72MN0404	1/4"	04	1/4-18	15	28	0,028	
72MN0604	1/4"	04	3/8-18	19	28	0,036	
72MN0405	5/16"	05	1/4-18	15	28	0,038	
72MN0605	5/16"	05	3/8-18	19	28	0,041	
72MN0406	3/8"	06	1/4-18	15	28	0,030	
72MN0606	3/8"	06	3/8-18	19	28	0,041	
72MN0806	3/8"	06	1/2-14	22	34	0,070	
72MN0608	1/2"	08	3/8-18	19	29	0,051	
72MN0808	1/2"	08	1/2-14	22	35	0,074	
72MN0810	5/8"	10	1/2-14	22	35	0,083	
72MN1210	5/8"	10	3/4-14	27	36	0,127	
72MN1212	3/4"	12	3/4-14	27	37	0,130	
72MN1612	3/4"	12	1-11.1/2	36	43	0,213	
72MN1616	1"	16	1-11.1/2	36	44	0,265	
72MN2016	1"	16	1.1/4-11.1/2	46	46	0,395	
72MN2020	1.1/4"	20	1.1/4-11.1/2	46	47	0,424	
72MN2424	1.1/2"	24	1.1/2-11.1/2	50	49	0,543	
72MN3232	2"	32	2-11.1/2	65	55	0,919	

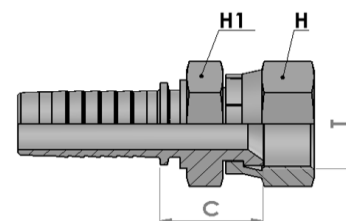
72FY
(TOYOTA)
FEMMINA DIRITTA "TOYOTA" SV.60°
"TOYOTA" STRAIGHT FEMALE 60° FLARE

part ref.	Hose ID		Thread	Dimension (mm)			Weight Kg
	[in]	size		hex H	hex H1	Cut-off C	
72FY0404	1/4"	04	1/4-19	19	19	19	0,044
72FY0606	3/8"	06	3/8-19	22	19	23	0,065
72FY0808	1/2"	08	1/2-14	27	27	26	0,105
72FY1212	3/4"	12	3/4-14	32	32	28	0,126
72FY1616	1"	16	1-11	38	36	31	0,261

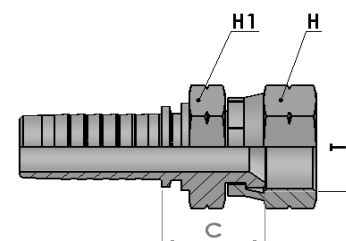
72FYM
(KOMATSU)
FEMMINA DIRITTA "KOMATSU" SV.60°
"KOMATSU" STRAIGHT FEMALE 60° FLARE

part ref.	Hose ID		Thread	Dimension (mm)			Weight Kg
	[in]	size		hex H	hex H1	Cut-off C	
72FYM1404	1/4"	04	M14-1.5	19	19	21	0,040
72FYM1605	5/16"	05	M16-1.5	22	19	22	0,040
72FYM1406	3/8"	06	M14-1.5	19	19	22	0,046
72FYM1806	3/8"	06	M18-1.5	24	22	25	0,072
72FYM2208	1/2"	08	M22-1.5	27	27	25	0,120
72FYM2408	1/2"	08	M24-1.5	30	27	25	0,140
72FYM2410	5/8"	10	M24-1.5	30	30	25	0,140
72FYM3012	3/4"	12	M30-1.5	36	36	31	0,206
72FYM3316	1"	16	M33-1.5	41	36	34	0,380
72FYM3620	1.1/4"	20	M36-1.5	46	46	38	0,420
72FYM4224	1.1/2"	24	M42-1.5	50	50	41	0,715

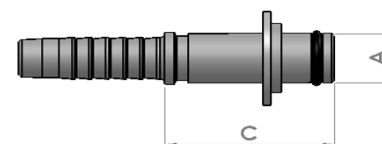
72KR10
ATTACCO PER PISTOLE IDROPULTRICI
GUN WASH CLEANER JUNCTION

part ref.	Hose ID		Dimension (mm)			Weight Kg
	[in]	size	Male A	Cut-off C		
72KR1004	1/4"	04	10	33		0,022
72KR1005	5/16"	05	10	33		0,029

72KR22 FEMMINA PER IDROPULTRICI

FEMALE FOR HIGH PRESSURE WATER JET CLEANER

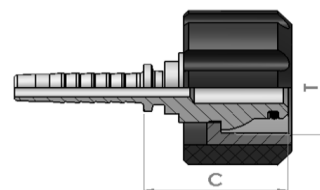

part ref.	Hose ID		Thread	Dimension (mm)		Weight
	[in]	size	T	Cut-off	C	Kg
72KR2204	1/4"	04	M 22x1,5	30		0,066
72KR2205	5/16"	05	M 22x1,5	30		0,071
72KR2206	3/8"	06	M 22x1,5	30		0,072

Dado lungo / long nut

72KR2204L	1/4"	04	M 22x1,5	30		0,078
72KR2205L	5/16"	05	M 22x1,5	30		0,067
72KR2206L	3/8"	06	M 22x1,5	30		0,067

72GT GIUNZIONE TUBO FLESSIBILE

FLEX HOSE JUNCTION

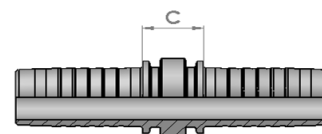

part ref.	Hose ID		Cut-off	Dimension (mm)		Weight
	[in]	size		C		Kg
72GT0303	3/16"	03	17			0,015
72GT0404	1/4"	04	17			0,020
72GT0505	5/16"	05	17			0,024
72GT0606	3/8"	06	17			0,040
72GT0808	1/2"	08	18			0,061
72GT1010	5/8"	10	18			0,086
72GT1212	3/4"	12	19			0,111
72GT1616	1"	16	21			0,221
72GT2020	1.1/4"	20	24			0,545

72SD

MASCHIO PER MINIERA STAPLELOCK DIN STAPLE-LOCK DIN MALE FOR MINING

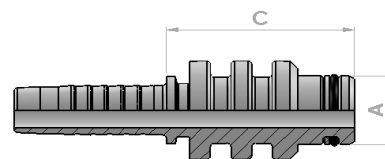

part ref.	Hose ID		Dimension (mm)				Weight Kg
	[in]	size	Male A	Cut-off C			
72SD2006	3/8"	06	20	37			0,053
72SD2408	1/2"	08	24	38			0,073
72SD2910	5/8"	10	29	33			0,150
72SD2912	3/4"	12	29	34			0,183
72SD3919	1"	16	39	41			0,233
72SD4620	1.1/4"	20	46	43			0,353

72SS

MASCHIO PER MINIERA STAPLELOCK SAE STAPLE-LOCK SAE MALE FOR MINING

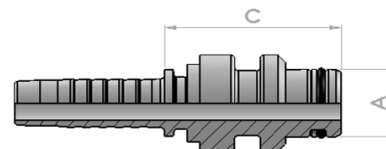

part ref.	Hose ID		Dimension (mm)				Weight Kg
	[in]	size	Male A	Cut-off C			
72SS2006	3/8"	06	20	35			0,051
72SS2408	1/2"	08	24	36			0,078
72SS2912	3/4"	12	29	36			0,121
72SS3916	1"	16	39	42			0,267
72SS4620	1.1/4"	20	46	44			0,415
72SS5520	1.1/2"	24	55	51			0,614
72SS6432	2"	32	64	47			1,018

72FL3 FLANGIA DIRITTA SAE 3000

STRAIGHT FLANGE SAE 3000

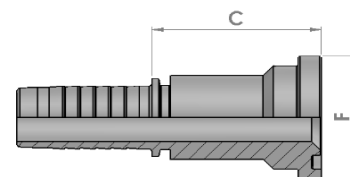

part ref.	Hose ID		Flange Size F	Flange F	Dimension (mm)			Weight Kg
	[in]	size			Cut-off C			
72FL30808	1/2"	08	1/2"	30,2	45		0,120	
72FL31208	1/2"	08	3/4"	38,1	50		0,157	
72FL31212	3/4"	12	3/4"	38,1	50		0,204	
72FL31612	3/4"	12	1"	44,5	53		0,252	
72FL31616	1"	16	1"	44,5	54		0,361	
72FL32016	1"	16	1.1/4"	50,8	57		0,366	
72FL32020	1.1/4"	20	1.1/4"	50,8	59		0,494	
72FL32420	1.1/4"	20	1.1/2"	60,4	62		0,570	
72FL32424	1.1/2"	24	1.1/2"	60,4	62		0,658	
72FL33224	1.1/2"	24	2"	71,4	67		0,845	
72FL33232	2"	32	2"	71,4	68		1,058	
72FL34032	2"	32	2.1/2"	84,1	70		1,320	
72FL34040	2.1/2"	40	2.1/2"	84,1	76		1,280	
72FL34848	3"	48	3"	101,6	87		2,400	

72FLN3 FLANGIA 90° SAE 3000

90° FLANGE SAE 3000

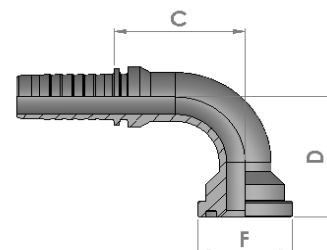

part ref.	Hose ID		Flange Size F	Flange F	Dimension (mm)			Weight Kg
	[in]	size			Cut-off C	Drop D		
72FLN30808	1/2"	08	1/2"	30,2	39	39	0,117	
72FLN31208	1/2"	08	3/4"	38,1	41	44	0,174	
72FLN31212	3/4"	12	3/4"	38,1	52	55	0,231	
72FLN31612	3/4"	12	1"	44,5	56	58	0,299	
72FLN31616	1"	16	1"	44,5	69	63	0,413	
72FLN32016	1"	16	1.1/4"	50,8	69	71	0,490	
72FLN32020	1.1/4"	20	1.1/4"	50,8	87	75	0,647	
72FLN32420	1.1/4"	20	1.1/2"	60,4	85	85	0,690	
72FLN32424	1.1/2"	24	1.1/2"	60,4	99	95	1,030	
72FLN33224	1.1/2"	24	2"	71,4	105	99	1,455	
72FLN33232	2"	32	2"	71,4	125	115	1,770	
72FLN34032*	2"	32	2.1/2"	84,1	125	120	1,890	
72FLN34040*	2.1/2"	40	2.1/2"	84,1	90	87	2,105	
72FLN34848*	3"	48	3"	101,6	115	106	2,790	

* SALDATA / WELDED

72FLQ3 **FLANGIA 45° SAE 3000**
45° FLANGE SAE 3000

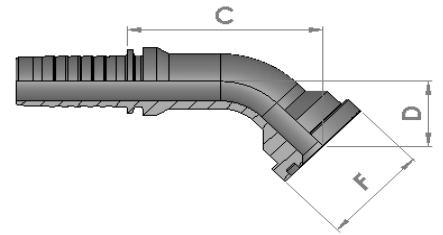

part ref.	Hose ID		Flange	Dimension (mm)			Weight
	[in]	size	Size F	Flange F	Cut-off C	Drop D	Kg
72FLQ30808	1/2"	08	1/2"	30,2	51	22	0,107
72FLQ31208	1/2"	08	3/4"	38,1	54	25	0,165
72FLQ31212	3/4"	12	3/4"	38,1	70	30	0,220
72FLQ31612	3/4"	12	1"	44,5	73	31	0,295
72FLQ31616	1"	16	1"	44,5	82	35	0,384
72FLQ32016	1"	16	1.1/4"	50,8	87	37	0,451
72FLQ32020	1.1/4"	20	1.1/4"	50,8	100	47	0,587
72FLQ32420	1.1/4"	20	1.1/2"	60,4	102	49	0,645
72FLQ32424	1.1/2"	24	1.1/2"	60,4	111	50	0,884
72FLQ33224	1.1/2"	24	2"	71,4	113	52	0,848
72FLQ33232	2"	32	2"	71,4	129	47	1,548
72FLQ34040*	2.1/2"	40	2.1/2"	84,1	75	30	1,430
72FLQ34848*	3"	48	3"	101,6	95	35	2,040

* SALDATA / WELDED

72FL6 **FLANGIA DIRITTA SAE 6000**
STRAIGHT FLANGE SAE 6000

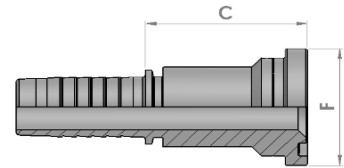

part ref.	Hose ID		Flange	Dimension (mm)			Weight
	[in]	size	Size F	Flange F	Cut-off C		Kg
72FL60808	1/2"	08	1/2"	31,7	46		0,121
72FL61208	1/2"	08	3/4"	41,3	53		0,203
72FL61212	3/4"	12	3/4"	41,3	54		0,244
72FL61612	3/4"	12	1"	47,6	60		0,316
72FL61616	1"	16	1"	47,6	61		0,395
72FL62016	1"	16	1.1/4"	54	68		0,500
72FL62020	1.1/4"	20	1.1/4"	54	70		0,608
72FL62420	1.1/4"	20	1.1/2"	63,5	76		0,803
72FL62424	1.1/2"	24	1.1/2"	63,5	76		0,849
72FL63224	1.1/2"	24	2"	79,4	85		1,155
72FL63232	2"	32	2"	79,4	85		1,327

72FLN6 **FLANGIA 90° SAE 6000**
90° FLANGE SAE 6000

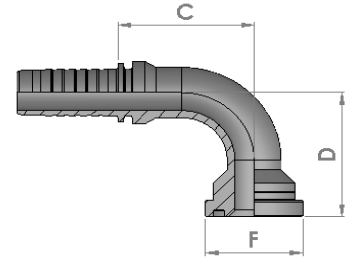

part ref.	Hose ID		Flange	Dimension (mm)			Weight
	[in]	size	Size F	Flange F	Cut-off C	Drop D	Kg
72FLN60808	1/2"	08	1/2"	31,7	39	39	0,120
72FLN61208	1/2"	08	3/4"	41,3	39	43	0,200
72FLN61212	3/4"	12	3/4"	41,3	56	57	0,249
72FLN61612	3/4"	12	1"	47,6	56	64	0,349
72FLN61616	1"	16	1"	47,6	70	70	0,467
72FLN62016	1"	16	1.1/4"	54	70	77	0,575
72FLN62020	1.1/4"	20	1.1/4"	54	83	81	0,895
72FLN62420	1.1/4"	20	1.1/2"	63,5	85	96	0,869
72FLN62424	1.1/2"	24	1.1/2"	63,5	102	107	1,400
72FLN63224	1.1/2"	24	2"	79,4	99	116	1,780
72FLN63232	2"	32	2"	79,4	125	136	2,240

72FLQ6 **FLANGIA 45° SAE 6000**
45° FLANGE SAE 6000

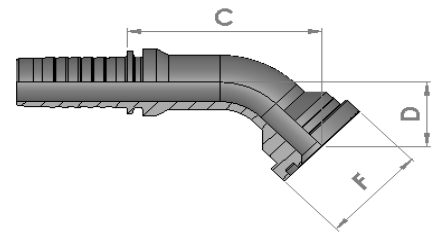

part ref.	Hose ID		Flange	Dimension (mm)			Weight
	[in]	size	Size F	Flange F	Cut-off C	Drop D	Kg
72FLQ60808	1/2"	08	1/2"	31,7	51	22	0,107
72FLQ61208	1/2"	08	3/4"	41,3	57	28	0,197
72FLQ61212	3/4"	12	3/4"	41,3	72	30	0,248
72FLQ61612	3/4"	12	1"	47,6	76	34	0,325
72FLQ61616	1"	16	1"	47,6	85	36	0,419
72FLQ62016	1"	16	1.1/4"	54	90	41	0,530
72FLQ62020	1.1/4"	20	1.1/4"	54	104	51	0,882
72FLQ62420	1.1/4"	20	1.1/2"	63,5	109	56	0,852
72FLQ62424	1.1/2"	24	1.1/2"	63,5	118	57	1,065
72FLQ63224	1.1/2"	24	2"	79,4	127	66	1,758
72FLQ63232	2"	32	2"	79,4	145	71	1,854

72FL9 FLANGIA DIRITTA SUPERCAT STRAIGHT FLANGE SUPERCAT

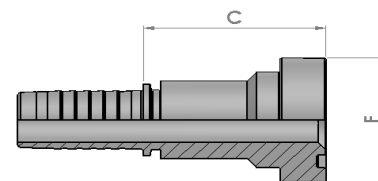

part ref.	Hose ID		Flange	Dimension (mm)			Weight
	[in]	size	Size F	Flange F	Cut-off C		Kg
72FL91212	3/4"	12	3/4"	41,3	57		0,293
72FL91612	3/4"	12	1"	47,6	64		0,381
72FL91616	1"	16	1"	47,6	65		0,469
72FL92016	1"	16	1.1/4"	54	72		0,561
72FL92020	1.1/4"	20	1.1/4"	54	74		0,699
72FL92420	1.1/4"	20	1.1/2"	63,5	78		0,885
72FL92424	1.1/2"	24	1.1/2"	63,5	80		0,875

72FLN9 FLANGIA 90° SUPERCAT 90° FLANGE SUPERCAT

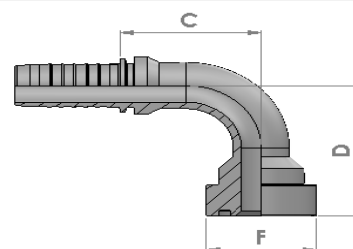

part ref.	Hose ID		Flange	Dimension (mm)			Weight
	[in]	size	Size F	Flange F	Cut-off C	Drop D	Kg
72FLN91212	3/4"	12	3/4"	41,3	56	61	0,355
72FLN91612	3/4"	12	1"	47,6	56	65	0,392
72FLN91616	1"	16	1"	47,6	71	78	0,577
72FLN92016	1"	16	1.1/4"	54	71	84	0,668
72FLN92020	1.1/4"	20	1.1/4"	54	90	86	0,905
72FLN92420	1.1/4"	20	1.1/2"	63,5	90	92	0,960
72FLN92424	1.1/2"	24	1.1/2"	63,5	108	104	1,455

72FLQ9 FLANGIA 45° SUPERCAT 45° FLANGE SUPERCAT

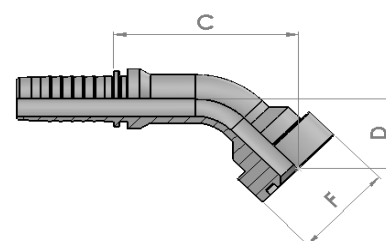

part ref.	Hose ID		Flange	Dimension (mm)			Weight
	[in]	size	Size F	Flange F	Cut-off C	Drop D	Kg
72FLQ91212	3/4"	12	3/4"	41,3	75	33	0,295
72FLQ91612	3/4"	12	1"	47,6	79	37	0,392
72FLQ91616	1"	16	1"	47,6	92	41	0,522
72FLQ92016	1"	16	1.1/4"	54,0	92	42	0,621
72FLQ92020	1.1/4"	20	1.1/4"	54,0	112	44	0,885
72FLQ92420	1.1/4"	20	1.1/2"	63,5	114	48	0,865
72FLQ92424	1.1/2"	24	1.1/2"	63,5	125	50	1,360

VS FLUID HYDRAULICS



INTERLOCK AND
WATERBLAST

71805 **BOCCOLA PER TUBO 4SH-R12**
FERRULE FOR HOSES 4SH-R12

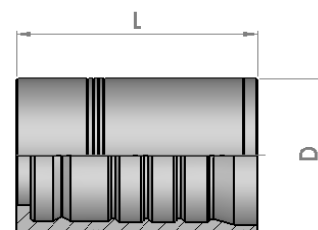

part ref.	Hose ID		Hose type	Dimension (mm)		Weight Kg
	[in]	size		Ext D	Length L	
7180205	1.1/4"	20	4SH-R12	55	88	0,463
7180245	1.1/2"	24	4SH-R12	62	94	0,580
7180325	2"	32	4SH-R12	78	99	0,911

71905 **BOCCOLA PER TUBO R12-R13-R15-4SH**
FERRULE FOR HOSES R12-R13-R15-4SH

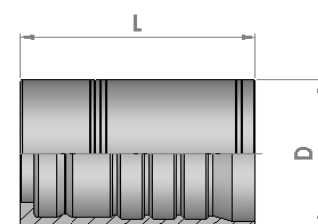

part ref.	Hose ID		Hose type	Dimension (mm)		Weight Kg
	[in]	size		Ext D	Length L	
7190125	3/4"	12	R12-R13-R15-4SH	38	60	0,165
7190165	1"	16	R12-R13-R15-4SH	46	74,5	0,291
7190205	1.1/4"	20	R13-R15-4SP	60	88	0,520
7190245	1.1/2"	24	R13-R15	67	94	0,664
7190325	2"	32	R13	84,5	99	1,164

72MC5 **MASCHIO BSPT CONICO SV.60°**
BSPT TAPARED MALE 60° FLARE

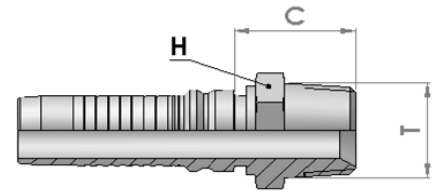

part ref.	Hose ID		Thread	Dimension (mm)			Weight Kg
	[in]	size		hex H	Cut-off C	T	
72MC12125	3/4"	12	3/4-14	30	35		0,156
72MC16165	1"	16	1-11	36	41		0,280
72MC20205	1.1/4"	20	1.1/4-11	46	44		0,497
72MC24245	1.1/2"	24	1.1/2-11	50	47		0,598
72MC32325	2"	32	2-11	65	54		1,437

72FG5 **FEMMINA DIRITTA BSPP SPINATA SV.60°**
CON O-RING
BSPP O-RING STRAIGHT FEMALE 60° FLARE THRUST
WIRE NUT

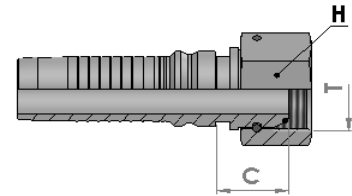

part ref.	Hose ID		Thread	Dimension (mm)			Weight Kg
	[in]	size		hex H	Cut-off C	T	
72FG12125	3/4"	12	3/4-14	32	23		0,192
72FG16165	1"	16	1-11	38	26		0,281
72FG20205	1.1/4"	20	1.1/4-11	50	29		0,530
72FG24245	1.1/2"	24	1.1/2-11	55	31		0,635
72FG32325	2"	32	2-11	70	30		1,228

72NG5 **FEMMINA 90° BSPP SPINATA SV.60° CON O-RING**
BSPP O-RING 90° FEMALE 60° FLARE THRUST WIRE NUT

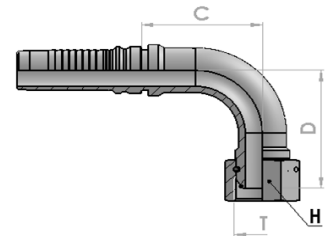

part ref.	Hose ID		Thread	Dimension (mm)			Weight Kg
	[in]	size		hex H	Cut-off C	Drop D	
72NG12125	3/4"	12	3/4-14	32	54	59	0,337
72NG16165	1"	16	1-11	38	69	72	0,519
72NG20205	1.1/4"	20	1.1/4-11	50	88	79	0,927
72NG24245	1.1/2"	24	1.1/2-11	55	98	95	1,292
72NG32325	2"	32	2-11	70	128	132	2,430

72QG5

FEMMINA 45° BSPP SPINATA SV.60° CON O-RING BSPP O-RING 45° FEMALE 60° FLARE THRUST WIRE NUT

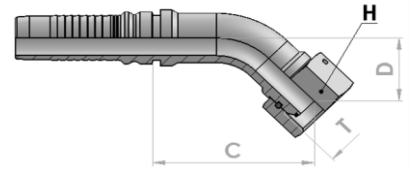

part ref.	Hose ID		Thread	Dimension (mm)			Weight Kg
	[in]	size		hex H	Cut-off C	Drop D	
72QG12125	3/4"	12	3/4-14	32	70	28	0,295
72QG16165	1"	16	1-11	38	87	38	0,490
72QG20205	1.1/4"	20	1.1/4-11	50	101	49	0,854
72QG24245	1.1/2"	24	1.1/2-11	55	119	59	1,170
72QG32325	2"	32	2-11	70	141	68	2,080

72MJ5

MASCHIO JIC SV.74° JIC MALE 74° FLARE

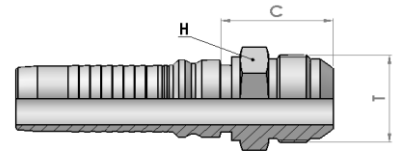

part ref.	Hose ID		Thread	Dimension (mm)			Weight Kg
	[in]	size		hex H	Cut-off C		
72MJ12125	3/4"	12	1.1/16-12	27	36		0,160
72MJ16165	1"	16	1.5/16-12	34	40		0,260
72MJ20205	1.1/4"	20	1.5/8-12	42	44		0,450
72MJ24245	1.1/2"	24	1.7/8-12	50	49		0,950
72MJ32325	2"	32	2.1/2-12	65	61		1,100

72FJ5

FEMMINA DIRITTA JIC SPINATA SV.74° JIC STRAIGHT FEMALE 74° FLARE THRUST WIRE NUT

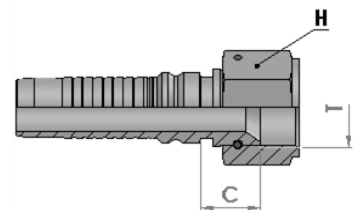

part ref.	Hose ID		Thread	Dimension (mm)			Weight Kg
	[in]	size		hex H	Cut-off C		
72FJ12125	3/4"	12	1.1/16-12	32	19		0,186
72FJ16165	1"	16	1.5/16-12	41	23		0,337
72FJ20205	1.1/4"	20	1.5/8-12	50	26		0,553
72FJ24245	1.1/2"	24	1.7/8-12	55	29		0,679
72FJ32325	2"	32	2.1/2-12	70	30		1,200

72NJ5

FEMMINA 90° JIC SPINATA SV.74° JIC 90° FEMALE 74° FLARE THRUST WIRE NUT

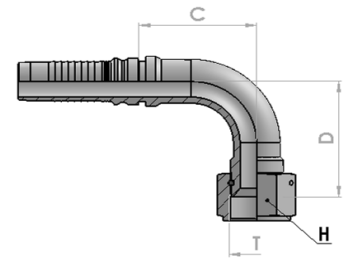

part ref.	Hose ID		Thread	Dimension (mm)				Weight Kg
	[in]	size		hex T	hex H	Cut-off C	Drop D	
72NJ12125	3/4"	12	1.1/16-12	32	51	55	0,275	
72NJ16165	1"	16	1.5/16-12	41	66	75	0,591	
72NJ20205	1.1/4"	20	1.5/8-12	50	88	82	0,910	
72NJ24245	1.1/2"	24	1.7/8-12	55	98	96	1,314	
72NJ32325	2"	32	2.1/2-12	70	122	132	2,440	

72QJ5

FEMMINA 45° JIC SPINATA SV.74° JIC 45° FEMALE 74° FLARE THRUST WIRE NUT

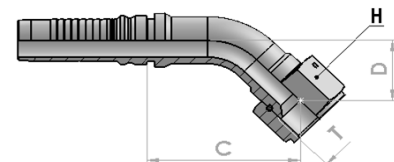

part ref.	Hose ID		Thread	Dimension (mm)				Weight Kg
	[in]	size		hex T	hex H	Cut-off C	Drop D	
72QJ12125	3/4"	12	1.1/16-12	32	63	33	0,275	
72QJ16165	1"	16	1.5/16-12	41	81	36	0,545	
72QJ20205	1.1/4"	20	1.5/8-12	50	103	50	0,910	
72QJ24245	1.1/2"	24	1.7/8-12	55	117	58	1,180	
72QJ32325	2"	32	2.1/2-12	70	141	68	2,440	

72MS5

MASCHIO METRICO SV.24° DKOS PESANTE METRIC MALE 24° FLARE S TYPE

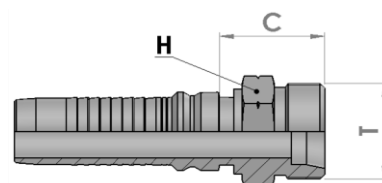

part ref.	Hose ID		Thread	Dimension (mm)				Weight Kg
	[in]	size		hex H	Tube T	Cut-off C		
72MS30125	3/4"	12	M30-2	30	20	32	0,156	
72MS36125	3/4"	12	M36-2	36	25	36	0,218	
72MS42165	1"	16	M42-2	46	30	39	0,365	
72MS52205	1.1/4"	20	M52-2	55	38	47	0,545	

72FS5

FEMMINA DIRITTA METRICA SV.24° DKOS METRIC STRAIGHT FEMALE 24° FLARE S TYPE

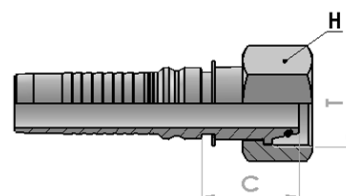

part ref.	Hose ID		Thread	Dimension (mm)				Weight Kg
	[in]	size		hex H	Tube T	Cut-off C		
72FS30125	3/4"	12	M30-2	36	20	31	0,238	
72FS36125	3/4"	12	M36-2	46	25	37	0,380	
72FS36165	1"	16	M36-2	46	25	38	0,397	
72FS42165	1"	16	M42-2	50	30	41	0,479	
72FS42205	1.1/4"	20	M42-2	50	30	42	0,580	
72FS52205	1.1/4"	20	M52-2	60	38	42	0,702	
72FS52245	1.1/2"	24	M52-2	60	38	42	0,729	

72NS5

FEMMINA 90° METRICA SV.24° DKOS 90° METRIC FEMALE 24° FLARE S TYPE

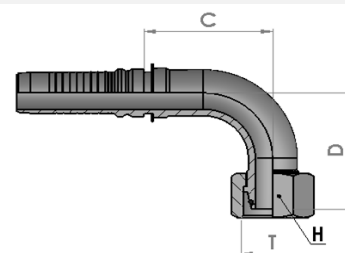

part ref.	Hose ID		Thread	Dimension (mm)				Weight Kg
	[in]	size		hex H	Tube T	Cut-off C	Drop D	
72NS30125	3/4"	12	M30-2	41	20	55	55	0,334
72NS36125	3/4"	12	M36-2	46	25	53	57	0,474
72NS42165	1"	16	M42-2	50	30	69	65	0,708
72NS52205	1.1/4"	20	M52-2	60	38	80	82	1,285

72QS5

FEMMINA 45° METRICA SV.24° DKOS 45° METRIC FEMALE 24° FLARE S TYPE

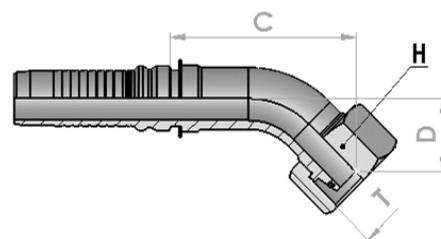

part ref.	Hose ID		Thread	Dimension (mm)				Weight Kg
	[in]	size		hex H	Tube	Cut-off C	Drop D	
72QS30125	3/4"	12	M30-2	41	20	70	30	0,297
72QS36125	3/4"	12	M36-2	46	25	71	31	0,308
72QS42165	1"	16	M42-2	50	30	80	33	0,631
72QS52205	1.1/4"	20	M52-2	60	38	99	47	1,097

72MN5

MASCHIO NPT SV.60° NPT MALE 60° FLARE

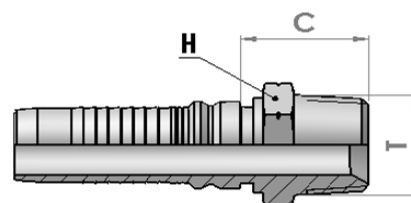

part ref.	Hose ID		Thread	Dimension (mm)			Weight Kg
	[in]	size		hex H	Cut-off C		
72MN12125	3/4"	12	3/4-14	30	35		0,155
72MN16165	1"	16	1-11.1/2	36	41		0,283
72MN20205	1.1/4"	20	1.1/4-11.1/2	46	44		0,497
72MN24245	1.1/2"	24	1.1/2-11.1/2	50	47		0,598
72MN32325	2"	32	2-11.1/2	65	54		1,180

72FH5 **FEMMINA DIRITTA ORFS**
ORFS STRAIGHT FEMALE

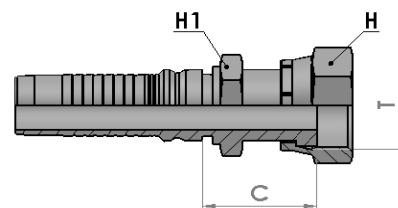

part ref.	Hose ID		Thread	Dimension (mm)			Weight Kg
	[in]	size		hex H	hex H1	Cut-off C	
72FH12125	3/4"	12	1.3/16-12	36	30	41	0,267
72FH16125	3/4"	12	1.7/16-12	41	36	43	0,358
72FH16165	1"	16	1.7/16-12	41	36	44	0,368
72FH20205	1.1/4"	20	1.11/16-12	50	46	50	0,629
72FH24245	1.1/2"	24	2-12	60	50	52	0,806

72NH5 **FEMMINA 90° ORFS**
90° ORFS FEMALE

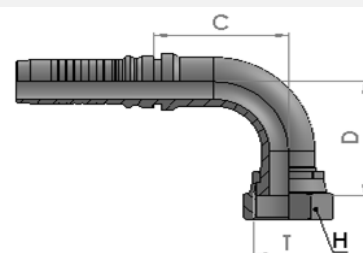

part ref.	Hose ID		Thread	Dimension (mm)			Weight Kg
	[in]	size		hex H	Cut-off C	Drop D	
72NH12125	3/4"	12	1.3/16-12	36	58	53	0,330
72NH16165	1"	16	1.7/16-12	41	72	68	0,526
72NH20205	1.1/4"	20	1.11/16-12	50	88	83	0,984
72NH24245	1.1/2"	24	2-12	60	106	94	1,379

72QH5 **FEMMINA 45° ORFS**
45° ORFS FEMALE

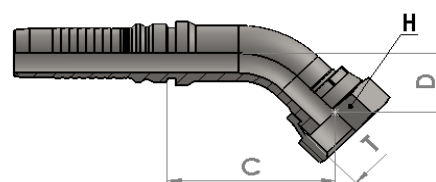

part ref.	Hose ID		Thread	Dimension (mm)			Weight Kg
	[in]	size		hex H	Cut-off C	Drop D	
72QH12125	3/4"	12	1.3/16-12	36	70	29	0,330
72QH16165	1"	16	1.7/16-12	41	80	32	0,526
72QH20205	1.1/4"	20	1.11/16-12	50	103	37	0,984
72QH24245	1.1/2"	24	2-12	60	116	43	1,379

72FL35 FLANGIA DIRITTA SAE 3000

STRAIGHT FLANGE SAE 3000

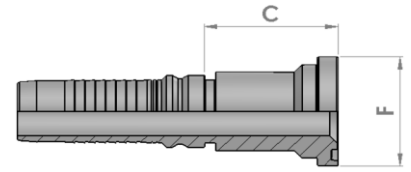

part ref.	Hose ID		Flange	Dimension (mm)			Weight
	[in]	size	Size F	Flange F	Cut-off C		Kg
72FL312125	3/4"	12	3/4"	38,1	47		0,248
72FL316125	3/4"	12	1"	44,5	50		0,288
72FL316165	1"	16	1"	44,5	52		0,393
72FL320165	1"	16	1.1/4"	50,8	55		0,408
72FL320205	1.1/4"	20	1.1/4"	50,8	56		0,560
72FL324205	1.1/4"	20	1.1/2"	60,4	59		0,600
72FL324245	1.1/2"	24	1.1/2"	60,4	60		0,727
72FL332245	1.1/2"	24	2"	71,4	65		1,215
72FL332325	2"	32	2"	71,4	67		1,365

72FLN35 FLANGIA 90° SAE 3000

90° FLANGE SAE 3000

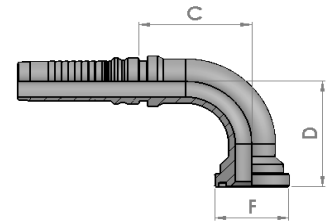

part ref.	Hose ID		Flange	Dimension (mm)			Weight
	[in]	size	Size F	Flange F	Cut-off C	Drop D	Kg
72FLN312125	3/4"	12	3/4"	38,1	49	55	0,315
72FLN316125	3/4"	12	1"	44,5	54	58	0,380
72FLN316165	1"	16	1"	44,5	67	66	0,492
72FLN320165	1"	16	1.1/4"	50,8	69	75	0,586
72FLN320205	1.1/4"	20	1.1/4"	50,8	88	78	0,777
72FLN324205	1.1/4"	20	1.1/2"	60,4	88	85	0,950
72FLN324245	1.1/2"	24	1.1/2"	60,4	105	90	1,256
72FLN332245	1.1/2"	24	2"	71,4	98	90	2,430
72FLN332325	2"	32	2"	71,4	126	110	2,618

72FLQ35 FLANGIA 45° SAE 3000

45° FLANGE SAE 3000

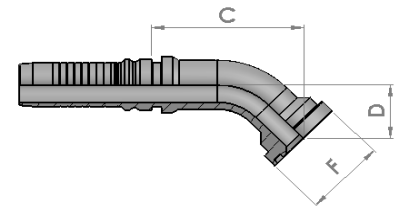

part ref.	Hose ID		Flange	Dimension (mm)			Weight
	[in]	size	Size F	Flange F	Cut-off C	Drop D	Kg
72FLQ312125	3/4"	12	3/4"	38,1	71	33	0,255
72FLQ316125	3/4"	12	1"	44,5	71	31	0,325
72FLQ316165	1"	16	1"	44,5	84	35	0,431
72FLQ320165	1"	16	1.1/4"	50,8	88	39	0,525
72FLQ320205	1.1/4"	20	1.1/4"	50,8	98	46	0,663
72FLQ324205	1.1/4"	20	1.1/2"	60,4	100	48	0,783
72FLQ324245	1.1/2"	24	1.1/2"	60,4	134	41	1,045
72FLQ332245	1.1/2"	24	2"	71,4	134	41	1,925
72FLQ332325	2"	32	2"	71,4	132	47	2,106

72FL65 **FLANGIA DIRITTA SAE 6000**
STRAIGHT FLANGE SAE 6000

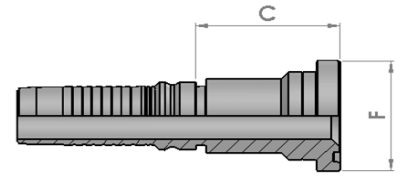

part ref.	Hose ID		Flange	Dimension (mm)			Weight
	[in]	size	Size F	Flange F	Cut-off C		Kg
72FL612125	3/4"	12	3/4"	41,3	51		0,290
72FL616125	3/4"	12	1"	47,6	57		0,385
72FL616165	1"	16	1"	47,6	59		0,444
72FL620165	1"	16	1.1/4"	54	66		0,529
72FL620205	1.1/4"	20	1.1/4"	54	67		0,989
72FL624205	1.1/4"	20	1.1/2"	63,5	73		0,836
72FL624245	1.1/2"	24	1.1/2"	63,5	74		0,920
72FL632245	1.1/2"	24	2"	79,4	82		1,378
72FL632325	2"	32	2"	79,4	84		1,807

72FLN65 **FLANGIA 90° SAE 6000**
90° FLANGE SAE 6000

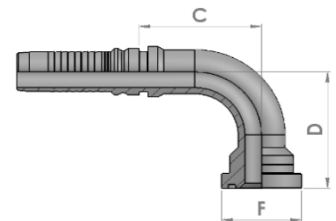

part ref.	Hose ID		Flange	Dimension (mm)			Weight
	[in]	size	Size F	Flange F	Cut-off C	Drop D	Kg
72FLN612125	3/4"	12	3/4"	41,3	54	57	0,327
72FLN616125	3/4"	12	1"	47,6	53	61	0,396
72FLN616165	1"	16	1"	47,6	69	74	0,546
72FLN620165	1"	16	1.1/4"	54	69	81	0,654
72FLN620205	1.1/4"	20	1.1/4"	54	88	82	0,981
72FLN624205	1.1/4"	20	1.1/2"	63,5	88	89	1,035
72FLN624245	1.1/2"	24	1.1/2"	63,5	105	102	1,466
72FLN632245	1.1/2"	24	2"	79,4	98	110	1,966
72FLN632325	2"	32	2"	79,4	132	132	2,864

72FLQ65 **FLANGIA 45° SAE 6000**
45° FLANGE SAE 6000

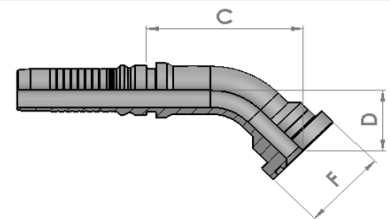

part ref.	Hose ID		Flange	Dimension (mm)			Weight
	[in]	size	Size F	Flange F	Cut-off C	Drop D	Kg
72FLQ612125	3/4"	12	3/4"	41,3	70	33	0,300
72FLQ616125	3/4"	12	1"	47,6	70	41	0,386
72FLQ616165	1"	16	1"	47,6	87	38	0,515
72FLQ620165	1"	16	1.1/4"	54	92	43	0,600
72FLQ620205	1.1/4"	20	1.1/4"	54	99	45	0,876
72FLQ624205	1.1/4"	20	1.1/2"	63,5	108	56	1,055
72FLQ624245	1.1/2"	24	1.1/2"	63,5	123	55	1,253
72FLQ632245	1.1/2"	24	2"	79,4	127	68	2,310
72FLQ632325	2"	32	2"	79,4	155	75	2,420

72FL95 **FLANGIA DIRITTA SUPERCAT**
STRAIGHT FLANGE SUPERCAT

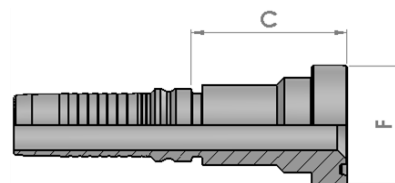

part ref.	Hose ID		Flange		Dimension (mm)			Weight Kg
	[in]	size	Size F	Flange F	Cut-off C			
72FL912125	3/4"	12	3/4"	41,3	55			0,329
72FL916165	1"	16	1"	47,6	62			0,475
72FL920205	1.1/4"	20	1.1/4"	54	71			0,732

72FLN95 **FLANGIA 90° SUPERCAT**
90° FLANGE SUPERCAT

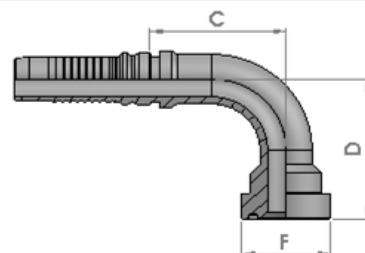

part ref.	Hose ID		Flange		Dimension (mm)			Weight Kg
	[in]	size	Size F	Flange F	Cut-off C	Drop D		
72FLN912125	3/4"	12	3/4"	41,3	56	62		0,360
72FLN916165	1"	16	1"	47,6	69	79		0,611
72FLN920205	1.1/4"	20	1.1/4"	54	88	86		0,992

72FLQ95 **FLANGIA 45° SUPERCAT**
45° FLANGE SUPERCAT

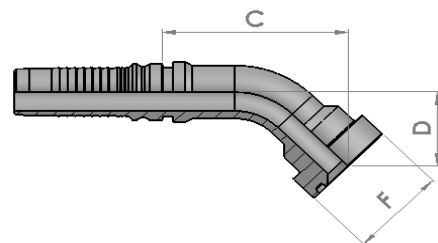

part ref.	Hose ID		Flange		Dimension (mm)			Weight Kg
	[in]	size	Size F	Flange F	Cut-off C	Drop D		
72FLQ912125	3/4"	12	3/4"	41,3	73	30		0,360
72FLQ916165	1"	16	1"	47,6	91	44		0,611
72FLQ920205	1.1/4"	20	1.1/4"	54	106	54		0,960

WATERBLAST

71745 **BOCCOLA PER TUBO WATERBLAST 4 SPIRALI**
FERRULE FOR WATERBLAST HOSES 4 SPIRALS

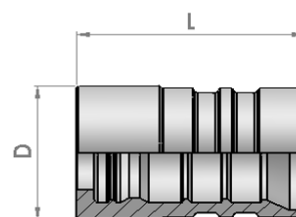

part ref.	Hose ID		Hose type	Dimension (mm)		Weight
	[in]	size		Ext D	Length L	Kg
7174085	1/2"	08	Waterblast 4 spir.	36	58	0,146
7174125	3/4"	12	Waterblast 4 spir.	42	65	0,270

WATERBLAST

71765 **BOCCOLA PER TUBO WATERBLAST 6 SPIRALI**
FERRULE FOR WATERBLAST HOSES 6 SPIRALS

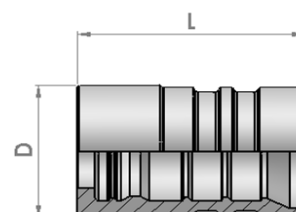

part ref.	Hose ID		Hose type	Dimension (mm)		Weight
	[in]	size		Ext D	Length L	Kg
7176085	1/2"	08	Waterblast 6 spir.	40	58	0,225
7176125	3/4"	12	Waterblast 6 spir.	44	65	0,290

WATERBLAST

72FWS5 **FEMMINA DIRITTA METRICA SV.24° DKOS**
METRIC STRAIGHT FEMALE 24° FLARE S TYPE

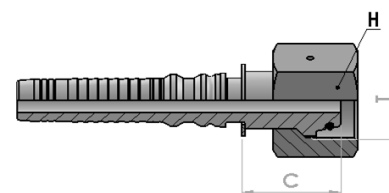

part ref.	Hose ID		Thread	Dimension (mm)				Weight Kg
	[in]	size		hex H	Tube	Cut-off C		
72FWS24085	1/2"	08	M24-1,5	32	16	34	0,181	
72FWS36125	3/4"	12	M36-2	46	25	44	0,461	

WATERBLAST

72MW **MASCHIO NPTF SV. 60°**
NPTF MALE 60° FLARE

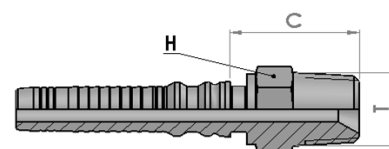

part ref.	Hose ID		Thread	Dimension (mm)				Weight Kg
	[in]	size		hex H	Cut-off C			
72MW08085	1/2"	08	1/2-14	22	37		0,145	
72MW12125	3/4"	12	3/4-14	27	38		0,180	

WATERBLAST

72FW5 **FEMMINA DIRITTA BSPP SV.60° CON DADO**
SPINATO
BSPP STRAIGHT FEMALE 60° FLARE THRUST WIRE NUT

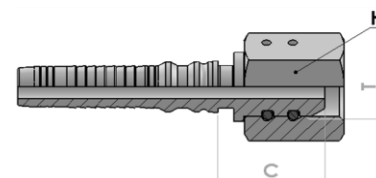

part ref.	Hose ID		Thread	Dimension (mm)				Weight Kg
	[in]	size		hex H	Cut-off C			
72FW08085	1/2"	08	1/2-14	30	32		0,199	

Avvertenze per l'utilizzo del tubo WATERBLAST

Warnings for use of WATERBLAST hose

L'utilizzo di tubi Waterblast è subordinato ad alcune regole, che in seguito andiamo ad elencare:

L'acqua ad alta pressione è estremamente pericolosa. I colpi di frusta causati dal posizionamento del tubo in pressione possono causare danni fisici, mentre le fuoriuscite del fluido, che a volte sono anche invisibili, sono in grado di perforare la pelle. Gli operatori che utilizzano prodotti assemblati Waterblast devono indossare indumenti protettivi, stivali e occhiali.

Si raccomanda di evitare l'utilizzo di raccordi e tubi di diverse provenienze, questo potrebbe causare il malfunzionamento dell'assemblato.

La temperatura dell'acqua deve essere sempre al di sotto dei 70°C.

Evitare la pressione pulsante e di superare la pressione di esercizio del tubo.

Utilizzare valvole di sicurezza per proteggere le persone e gli impianti.

Quando si utilizzano tubi raccordati Waterblast è obbligatorio l'uso di dispositivi di sicurezza dei raccordi come guaine di contenimento, cavi e catene. Se non fosse possibile applicare i suddetti dispositivi devono essere previste misure di uguale efficacia.

Tutti gli assemblaggi Waterblast prima dell'utilizzo devono essere testati al 150% della pressione di lavoro indicata sulla tubazione.

Evitare assolutamente di posizionare i tubi Waterblast sospesi verso il basso.

Si raccomanda di evitare torsioni, tensioni assiali, schiacciamenti e deformazioni sui tubi raccordati, nel caso si verificassero guasti bisogna sostituire l'assemblato.

The use of hoses Waterblast is subject to certain rules, are listed below:

The water under high pressure is extremely dangerous. The whiplash injury caused by the positioning of the hose under pressure may cause physical damage, while the leakage of the fluid, which sometimes are also invisible, are able to pierce the skin. The operators using assembled Waterblast products should be wear protective clothing, boots and glasses.

It is recommended to avoid the use of fittings and hose of different origins, this could cause the failure of the assembly.

The temperature of the water must be below 70°C.

Avoid the pulsating pressure and to exceed the operating pressure of the hose.

Use safety valves to protect persons and equipment.

When using hose assemblies Waterblast is mandatory the use of safety devices such as containment sleeves, cables and chains. If is impossible to apply the such devices, must be provided equally measures efficient.

All Waterblast assemblies must be tested before to use to 150% of the working pressure indicated on the hose.

Never to position the hoses Waterblast suspended downward.

It is recommended to avoid torsion, axial tension, crushing and deformation on hose assemblies, should be faulty must replace the assembly.

